

MECHANICAL PARTS LIST (CONT'D.)

Ref. Part No. No.	Description	Ref. Part No. No.	Description
40	Screw	78	Retaining Ring
41	Washer	79	Washer, Thrust
42	Bracket, Switch Lever Shut-off	80	Retainer, Bearing, Upper
43	Spring, Compression	81	Bearing
44	Washer	82	Washer, Thrust
45	"C" Washer	83	Washer, Felt
46	Lever, Start	84	Retainer, Ball Race
47	Lever, Set Down	85	Shaft
47A	Cam, Set Down Adjusting	86	Retainer, Spring
48	Segment	87	Spring, Compression
49	Shutoff Rail	88	Change Bolt
50	"C" Washer	89	Adjusting Cam, Drop Rocker
51	Main Lever	90	Retainer, Idler
52	Spring, Tension	91	Intermediate Wheel, 33rpm
53	Lever, Setting	92	Intermediate Wheel, 16rpm
54	Lever, Record Selector-Start- Reject Actuating	93	Washer
55	Spacer	94	Switch Segment
56	Bracket, Record Selector-Start- Reject Actuating Lever	95	Rocker
57	Selector, Record Size	96	"C" Washer
58	Washer, Spring	97	Lifter
59	Spacer	98	Mounting Plate, Motor
60	Screw	99	Motor
61	Spring, Tension	100	Mounting Screw, Motor
62	Spring, Tension	101	Mounting Screw, Motor
63	"C" Washer	102	Intermediate Wheel, 78rpm
64	Bracket, Bearing	103	Intermediate Wheel, 45rpm
65	Shaft	104	Lever, Speed Change
66	"C" Washer	105	Switch Piece
67	Spring, Compression	106	Washer, Spring
68	Lever, Shift	107	Eyelet
69	Cam Gear	108	Screw
70	Bracket, Bearing, Cam Gear and Spindle	109	"C" Washer
71	"C" Washer	110	Lever, Shift
72	Lever, Switch-over	111	Retainer
73	Spring, Tension	112	Idler Wheel
74	Drop Rocker	113	Washer, Fiber
75	Muting Switch	114	"C" Washer
76	Mounting Screws	115	Lever, Swing
77	Retaining Ring	116	Spring, Tension
		117	"C" Washer
		118	Lug

No manufacturer's information available.

SET 665 FOLDER 6

DUAL
MODEL C1007A

PHOTOFACT® Folder



DUAL
MODEL C1007A



TRADE NAME	Dual Model 1007A
SUPPLIER	United Audio Products, 12 W. 18th St., New York 11, New York
TYPE SET	AC Operated 4 Speed Automatic Record Changer for Playing 7", 8", 10", or 12" Records
POWER SUPPLY	110 - 120 Volts AC, 60 Cycles

DUAL
MODEL C1007A

SET 665 FOLDER 6

HOWARD W. SAMS & CO., INC. Indianapolis 6, Indiana



The listing of any available replacement part herein does not constitute in any case a recommendation, warranty or guaranty by Howard W. Sams & Co., Inc., as to the quality and suitability of such replacement part. The numbers of these parts have been compiled from information furnished to Howard W. Sams & Co., Inc., by the manufacturers of the particular type of replacement part listed.

Reproduction or use, without express permission, of editorial or pictorial content, in any manner, is prohibited. No patent liability is assumed with respect to the use of the information contained herein. © 1963 Howard W. Sams & Co., Inc., Indianapolis 6, Indiana. Printed in U. S. of America

DATE 11-63 SET 665 FOLDER 6

FUNCTION OF CONTROLS

Speed

Selects the correct speed for playing records. When moved to the dot, the idler wheel is disengaged.

Record Size Selector-Start-Reject

Sliding the knob to 7, 8, 10, or 12, whichever position corresponds to the record being played, determines the set-down position of the tone arm.

Depressing the knob starts the changer or will reject a record that is playing.

Stop

Depress the button and the changer will reject, causing the tone arm to return to its rest post and shuts the power off.

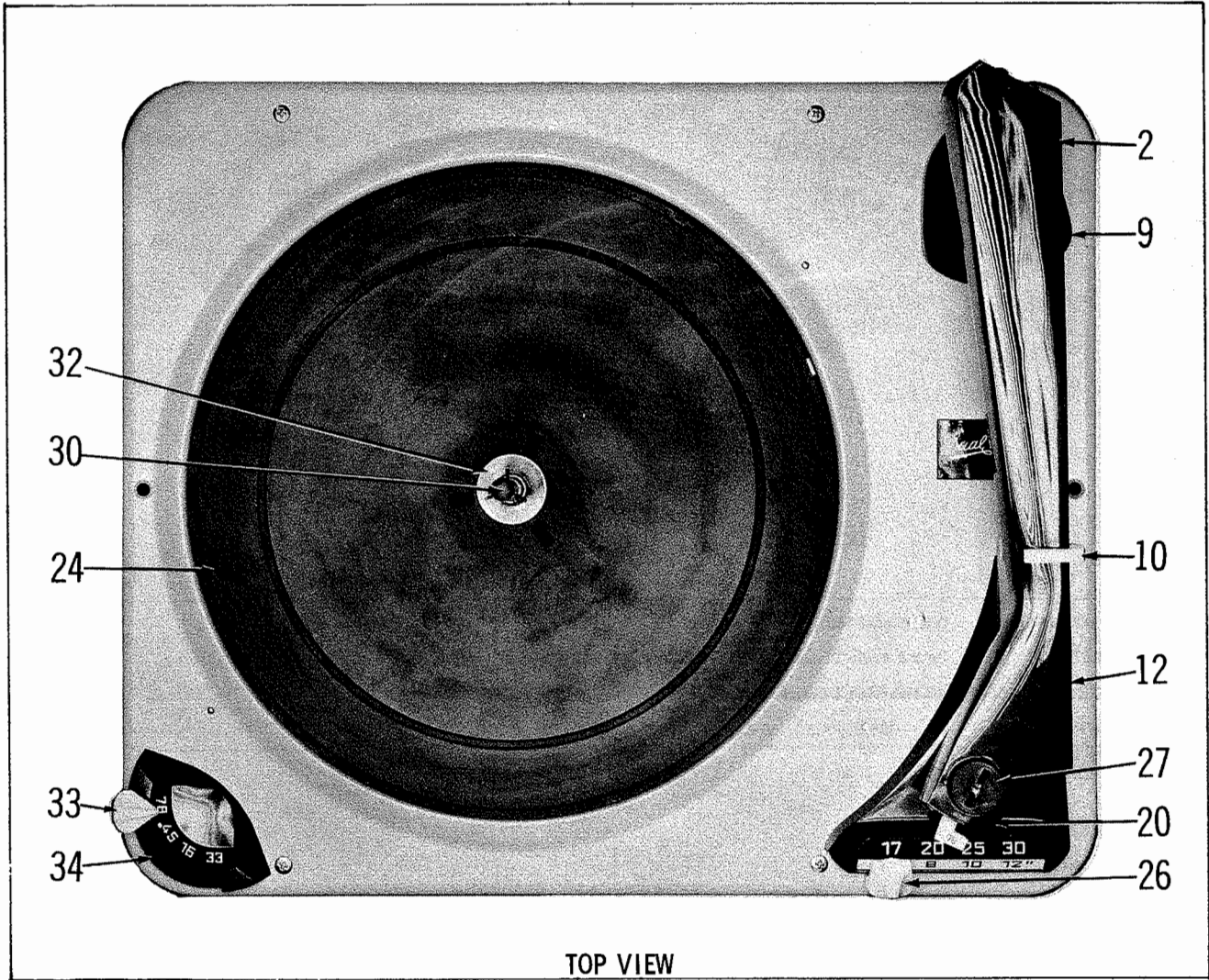

TOP VIEW

OPERATING INSTRUCTIONS

Automatic Changer

- 1. Insert the automatic spindle (30) into the hole in the turntable and turn clockwise to lock it in position.
- 2. Place up to ten records of the same size and speed on the spindle.
- 3. Select the correct speed, record size and stylus.
- 4. Depress the Record Size Selector-Start-Reject

- button to start the changer and play the first record of the stack.
- 5. To reject a record, depress the Record Size Selector-Start-Reject button.
- 6. To stop the changer, depress the Stop button and the tone arm will return to its rest post and if any records are on the spindle, the next record will drop to the turntable.

TROUBLE CHART

Symptom	Cause	Remedy
Changer does not start when start button is depressed.	1. AC switch defective.	1. Replace AC switch.
	2. Motor (99) defective.	2. Replace motor (99).
	3. Idler wheel (112) disengaged from motor shaft.	3. Move speed selector to the correct speed.
Stylus does not set down in the lead-in groove of the record.	1. Tone arm set-down out of adjustment.	1. See "Set Down" under "Adjustments".
Stylus skips on record.	1. Stylus pressure insufficient.	1. See "Stylus Pressure" under "Adjustments".
Will not change records when start button is depressed.	1. Automatic spindle (3) not locked in its housing.	1. Turn automatic spindle (3) clockwise to lock it in its housing.
	2. Spindle fingers are not retracted enough to permit a record to drop.	2. See "Record Drop" under "Adjustments".
Will not reject when tone arm enters leadout groove of record.	1. Shutoff rail (49) does not contact friction lever on cam gear (69) so it will engage the turntable.	1. If shutoff rail (49) is bent, remove and straighten. If segment (48) is loose on tone arm housing, tighten the two set screws.
	2. Friction lever on cam gear (69) bent, due to jamming.	2. Replace friction lever.
Will not reject when start or stop button is depressed.	1. Tension spring (61) broken or weak.	1. Replace tension spring (61).
Tone arm will not index properly.	1. Tension spring (62) weak or broken.	1. Replace tension spring (62).
Changer will not shut off when the Stop button is depressed.	1. Tension spring (61) broken or missing.	1. Replace tension spring (61).
	2. Defective AC switch.	2. Replace AC switch.

MECHANICAL PARTS LIST

Ref. Part No. No.	Description	Ref. Part No. No.	Description
1	Screw, Tone Arm Mounting	21	Bracket, Cartridge Mounting
2	Tone Arm	22	Hex Nut, Cartridge Mounting
3	Bearing Shaft	23	Cartridge
4	Bracket, Bearing	24	Mat, Turntable
5	Spring, Compression	25	Turntable
6	"C" Washer	26	Knob, Start-Reject-Record Size Selector
7	Spring, Spiral	27	Lock, Cartridge Mounting
8	Bearing, Bracket, Complete	28	"C" Washer
9	Housing, Bearing Bracket	29	Screw, Cartridge Mounting Bracket
10	Lock, Tone Arm	30	Spindle
11	Spring, Tension	31	Retaining Ring, Turntable
12	Escutcheon	32	Locking Disc
13	Spring, Stop Button	33	Knob, Speed Selector
14	Button, Stop	34	Escutcheon, Speed
15	Ball Bearing	35	"C" Washer
16	Plunger	36	Lift Rod
17	Spring, Tension	37	Actuating Lever, Stop
18	Screw	38	Spring, Compression
19	Plate, Slide	39	Bracket, Bearing, Record Selector-Start-Reject-Stop
20	Bracket, Cartridge Locking		

DUAL
MODEL C1007A

FOLDER 6

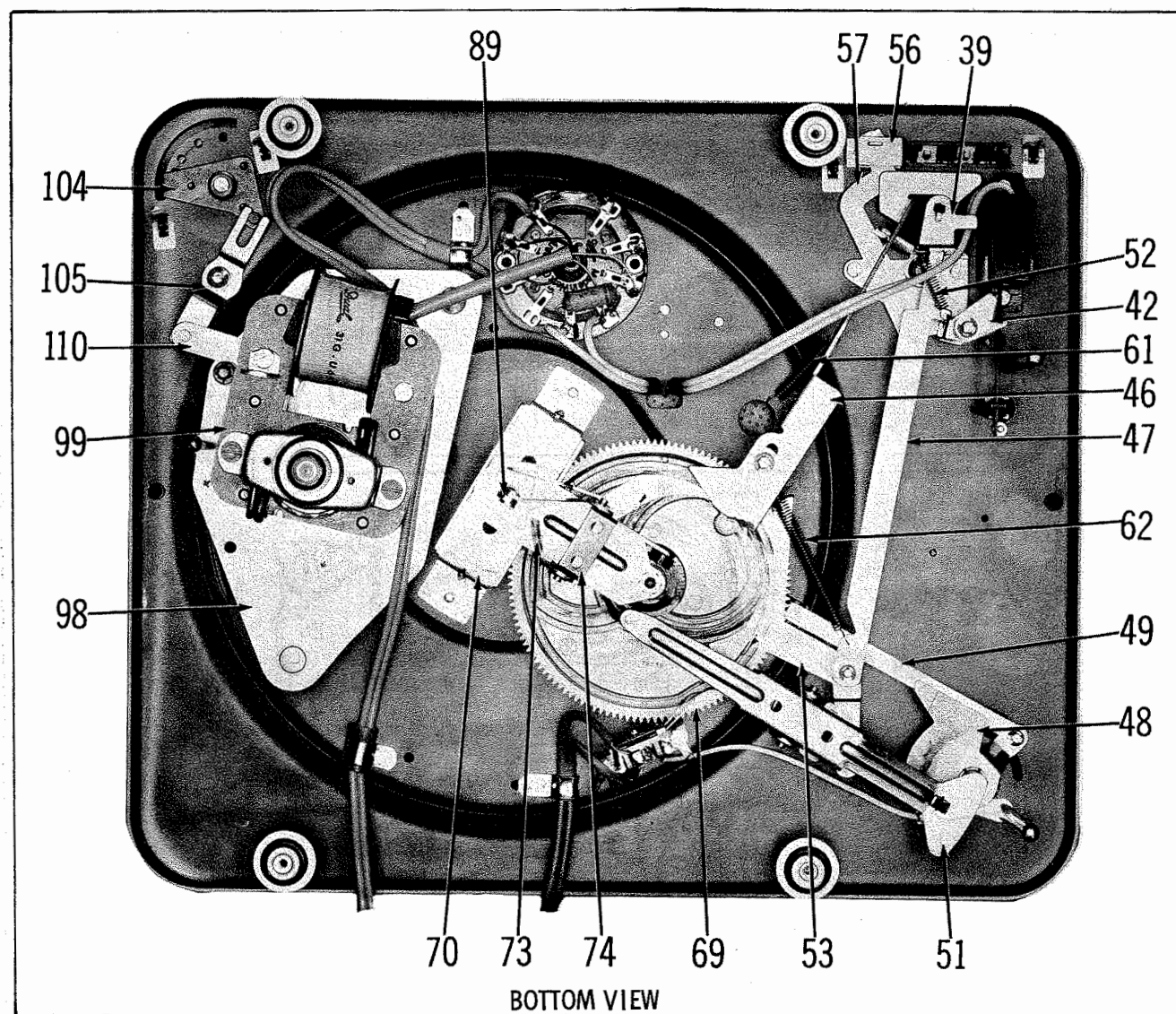

BOTTOM VIEW

ADJUSTMENTS

Stylus Pressure

Turn screw (3) clockwise to reduce the pressure and counterclockwise to increase the pressure.

Set Down

Turn cam screw (47A) clockwise to move the

tone arm in and counterclockwise to move it out.

Record Drop

Turn cam screw (89) to the right or left until the spindle fingers are retracted so a record will drop smoothly to the turntable.

CLEANING

Clean all sliding levers, inside rim of the turn-

table, idler wheel (112), and the plastic cam gear (69) with alcohol.

LUBRICATION

Apply a thin coat of nonhardening lubricant on all sliding levers.

Apply one or two drops of a good grade motor oil to the motor bearings.

Automatic Single Play

1. Insert the short spindle into the hole in the turntable.
2. Place a record on the turntable.
3. Select the correct speed, record size, and stylus.
4. Depress the Record Size Selector-Start-Reject button.
5. When the record is played, the tone arm will return to its rest post and turn the power off to the changer.

Manual Single Play

1. Place a record on the turntable.

2. Lift tone arm and place on lead-in groove of record.

3. At end of record, the tone arm will return to its post and the changer will shut off automatically.

Speed Selector

The speed selector is marked 33, 16, 45, and 78. It is to be set for the type records being played. The idler wheel (112) is disengaged when it is set to the dot.

Automatic 45RPM Play

1. Insert the 45rpm spindle into the center hole in the turntable. This is available as an extra accessory under part number AS6.
2. Follow the same procedure as in Automatic Changer.

CHANGE CYCLE

Observe the change cycle by manually rotating the turntable by hand. The following action can then be readily understood. In this explanation of the change cycle, the mechanism is assumed to have stopped automatically with the pickup arm resting on the rest post.

Depress the Record Size Selector-Start-Reject control to start the unit into automatic cycling. The movement of this control actuates the On-Off switch and start lever (46) which moves the cam gear (69) far enough to engage with the gear on the turntable. As cam gear (69) rotates, main lever (51) and drop rocker (74) are actuated simultaneously.

Main lever (51) rides in the groove of cam gear (69) as it rotates. As the cam gear (69) rotates, main lever (51) pushes lift rod (36) up and causes the clutch to contact segment (48) and lifts lift rod (36) to raise the tonearm and moves the tone arm in to set down on the lead-in groove of the record.

Just before the tone arm moves in and sets down on the lead-in groove of the record, drop rocker (74) rides on the inner cam of cam gear (69) and actuates change bolt (88) which actuates the fingers of automatic spindle (30) and lets a record drop onto the turntable as cam gear (69) continues to rotate to its out-of-cycle position.

After a record is played and the tone arm enters the lead-out groove of the record, shut-off rail (49)

strikes the friction lever on cam gear (69) and moves it so it will contact the gear of the turntable. This rotates the cam gear (69) so it and the turntable gear will mesh to start another change cycle.

To play records, move the Record Selector to the 7, 8, 10, or 12" position. When playing 7" records, the set-down adjusting cam (47A) will hit the first notch in the record size selector (57) and the tone arm assembly will move in to set down in the lead-in groove of the record. When 8" records are being played, the set-down adjusting cam (47A) hits the second notch on record size selector (57); on 10" records, the set-down adjusting cam (47A) hits the third notch on the record size selector (57); on 12" records, the set-down adjusting cam (47A) hits the fourth notch on the record size selector (57). The setting lever (53) will move out as far as permitted by the set-down adjusting cam when it hits the record size selector (57) for the correct setdown of records being played.

When the last record has played and the changer starts to cycle, switch-over lever (72) moves up and out so the shift lever (68) on cam gear (69) will hit it and be moved outward so main lever (51) will follow the outer groove of cam gear (69) so the tone arm will remain over its rest post and set down and actuate the on-off switch to turn the changer off when the change cycle is completed.

DUAL
MODEL C1007A

FOLDER 6

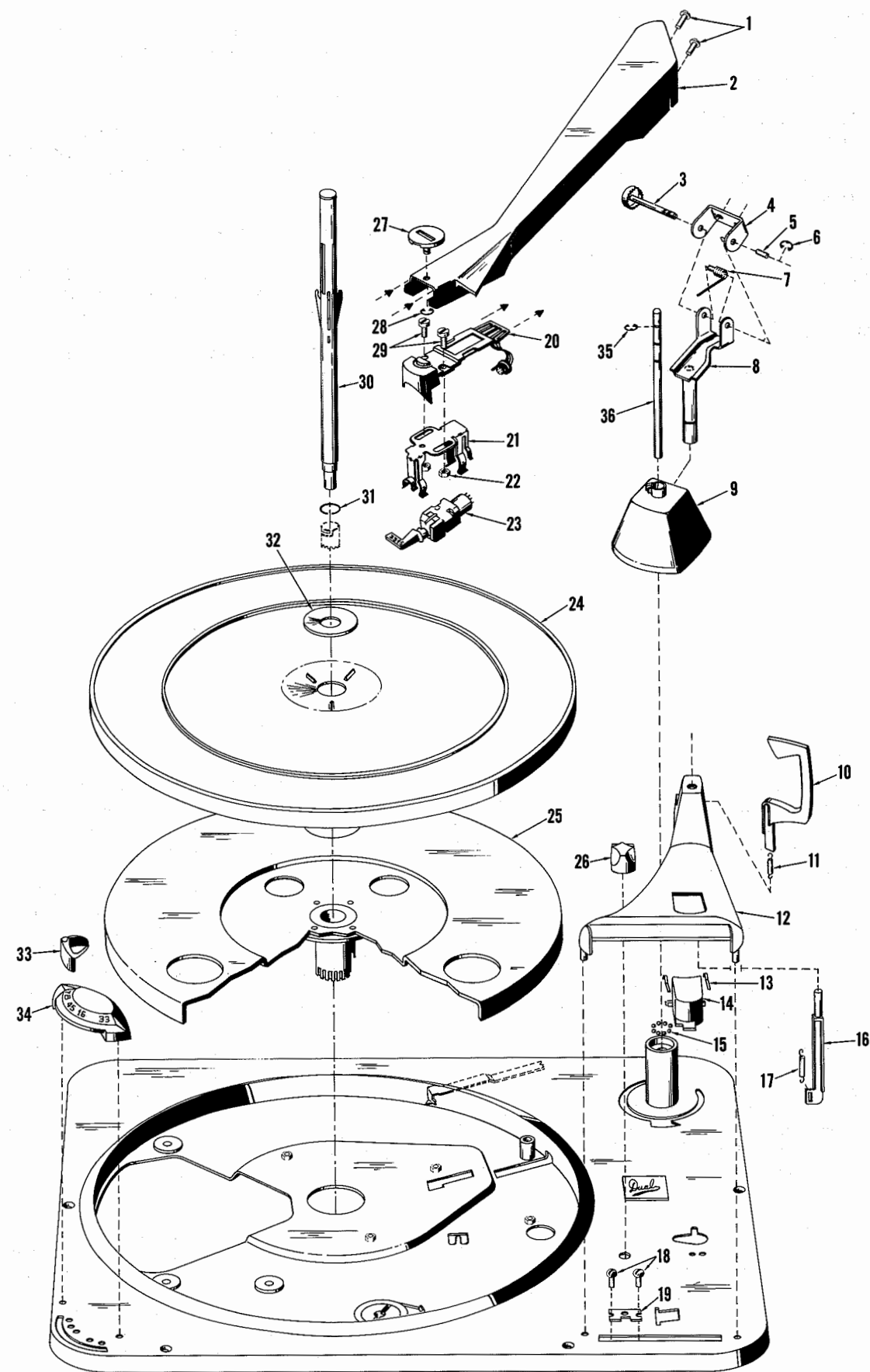

A PHOTOFACT "EXPLODED" VIEW
©Howard W. Sams & Co., Inc. 1963

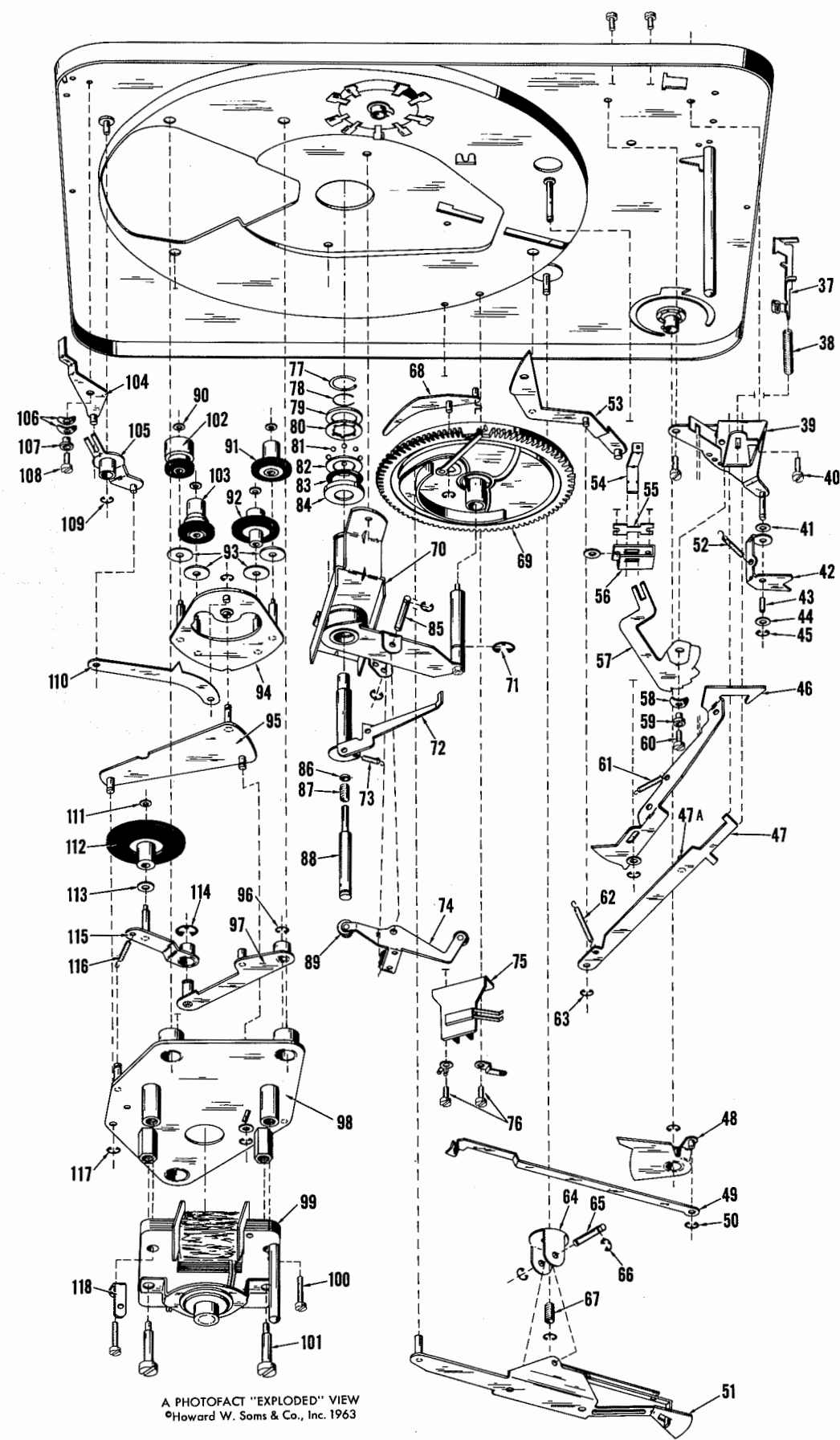

A PHOTOFACT "EXPLODED" VIEW
©Howard W. Sams & Co., Inc. 1963

DUAL
MODEL C1007A

FOLDER 6