

PHOTOFACT® Folder

with CIRCUITRACE™

ZENITH
CHASSIS 8YT20

For Supplier Address See PHOTOFACT Index

FOR SERVICE INFORMATION ON RECORD CHANGER—SEE SIMILAR CHANGER—PHOTOFACT SET 797, FOLDER 7.

ZENITH
CHASSIS 8YT20ZENITH
CHASSIS 8YT20

Zenith Models T2560W, Y547C/L, Y550W (Ch. 8YT20)

REMEMBER TO ASK— “What else needs fixing?”**HOWARD W. SAMS & CO., INC.** Indianapolis, Indiana 46206

The listing of any available replacement part herein does not constitute in any case a recommendation, warranty or guaranty by Howard W. Sams & Co., Inc., as to the quality and suitability of such replacement part. The numbers of these parts have been compiled from information furnished to Howard W. Sams & Co., Inc., by the manufacturers of the particular type of replacement part listed. SS739

Reproduction or use, without express permission, of editorial or pictorial content, in any matter, is prohibited. No patent liability is assumed with respect to the use of the information contained herein. © 1968 Howard W. Sams & Co., Inc., Indianapolis, Indiana 46206. Printed in U. S. of America.

DATE 7 -68

SET 967 FOLDER 8

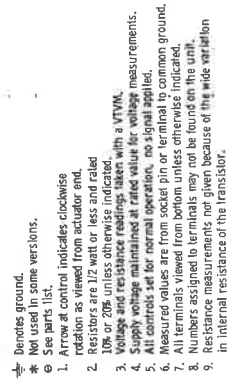

A PHOTOFACT STANDARD NOTATION SCHEMATIC

with **CIRCUITRACE**

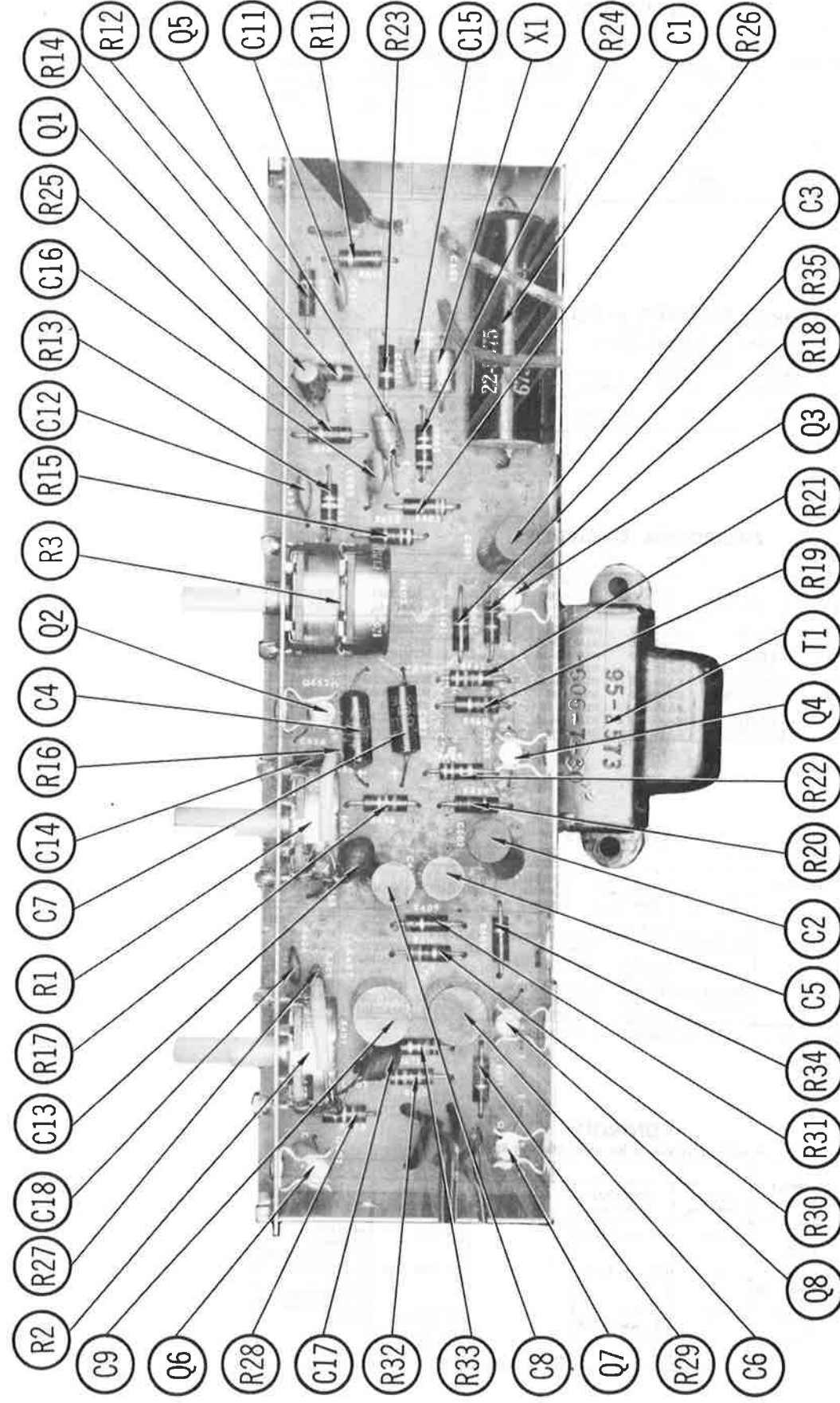

PARTS LIST AND DESCRIPTION

(When ordering parts, state Model, Part Number, and Description.)

TRANSISTORS

ITEM No.	TYPE No.	FUNCTION	REPLACEMENT DATA					
			MFGR. PART No.	DELCO PART No.	GENERAL ELECTRIC PART No.	INTERNATIONAL RECTIFIER PART No.	RCA PART No.	SYLVANIA PART No.
Q1		AF Amp	121-633	DS-26	GE-2	TR-14	SK-3004	ECG 102
Q2		AF Amp	121-632			TR-14	SK-3004	
Q3		Output	121-641					
Q4		Output	121-640					
Q5		AF Amp	121-633	DS-26	GE-2	TR-14	SK-3004	ECG 102
Q6		AF Amp	121-632			TR-14	SK-3004	
Q7		Output	121-641					
Q8		Output	121-640					

POWER RECTIFIERS & SIGNAL DIODES

ITEM No.	MFGR. PART OR TYPE No.	REPLACEMENT RECTIFIERS & DIODES			REPLACEMENT RECTIFIERS		NOTES
		GENERAL ELECTRIC PART No.	INTERNATIONAL RECTIFIER PART No.	SYLVANIA PART No.	RCA PART No.	SARKES TARZIAN PART No.	
X1	212-71	GE-504A	8D4 or 5A4-D	ECG 116 or ECG 117	SK-3030 or SK-3031	40C or F-4	

ELECTROLYTIC CAPACITORS

ITEM No.	RATING		REPLACEMENT DATA						
			ZENITH PART No.	AEROVOX PART No.	CENTRALAB PART No.	CORNELL-DUBILIER PART No.	GENERAL ELECTRIC PART No.	MALLORY PART No.	SPRAGUE PART No.
C1	500	25V	22-5475	PRS1290	EA30-500	BR500-25	QTI-31	TC2505B	TL-1217
C2	100	25V	22-5510	PTT86	EA30-100	NLW100-25	MT1-20	MTV100CP25	TL-1211
C3	100	20V	22-5511	PTT121	EA30-100	NLW100-25	MT1-20	MTV100CP25	TE-1211
C4	10	15V	22-3448	PTT66	EA15-10	NLW10-15	MT1-5	TT15X10	TL-1155
C5	100	20V	22-5511	PTT121	EA30-100	NLW100-25	MT1-20	MTV100CP25	TE-1211
C6	250	15V	22-5512	BCD15300	EA15-250	BR500-15	QTI-28	MTV250DE15	TL-1164.5
C7	10	15V	22-3448	PTT86	EA15-10	NLW10-15	MT1-5	TT15X10	TL-1155
C8	100	20V	22-5511	PTT121	EA30-100	NLW100-25	MT1-20	MTV100CP25	TE-1211
C9	250	15V	22-5512	BCD15300	EA15-250	BR500-15	QTI-28	MTV250DE15	TL-1164.5

CAPACITORS

ITEM No.	RATING	REMARKS	REPLACEMENT DATA					
			AEROVOX PART No.	CENTRALAB PART No.	CORNELL-DUBILIER PART No.	ELMENCO PART No.	MALLORY PART No.	SPRAGUE PART No.
C11	22 N330			TCA-22	JBT601YP472K	CCD-472	JF247	10TCS-Q22
C12	.0047		GPD X5R472K	DD-472G	WMF1D22	GDP-1-222	PVC6222	10TS-D47
C13	.022 50V		V1614D22		HCZ3R0XR224P		MAG3022	225P22291
C14	.22 3V			UK-224				HY-125
C15	22 N330			TCA-22	JBT601YP472K	CCD-472	JF247	10TCS-Q22
C16	.0047		GPD X5R472K	DD-472G	HCZ3R0XR224P		PVC6222	10TS-D47
C17	.022 50V		V1614D22	UK-224			MAG3022	225P22291
C18	.22 3V			UK-224	HCZ3R0XR224P			HY-125

* Not normally in distributor's stock. Available thru distributor on order to manufacturer.

CONTROLS

All wattages 1/2 watt, or less, unless otherwise listed.

ITEM No.	USE	RESIST-ANCE	REPLACEMENT DATA				
			ZENITH PART No.	CENTRALAB PART No.	CLAROSTAT PART No.	CTS-IRC PART No.	MALLORY PART No.
R1	Volume/Left	10K 3000Ω Tap	63-7384	F16-10K, SN100		B19-116X, TM4	RU14T53, SL37, SN1000 or (FA14T53, SF3000)
R2	Volume/Right	10K 3000Ω Tap	63-7384	F16-10K, SN100		B19-116X, TM4	RU14T53, SL37, SN1000 or (FA14T53, SF3000)
R3A	Tone/Left	100K	63-7383	F2-100K, R2-100K, SF100, CPL-2		B13-128, B13-128, TM5, QCM or (BU11, CF13, CR8, SS6, SS7A, DC1)*	FA15A, RU15A, CS3500
B	Tone/Right	100K					

* "SNAPTROL"

TRANSFORMER (POWER)

ITEM No.	RATING			REPLACEMENT DATA					NOTES
	PRI.	SEC. 1	SEC. 2	ZENITH PART No.	MERIT PART No.	STANCOR PART No.	THORDARSON PART No.	TRIAD PART No.	
T1	117VAC @.038A AC	15VAC @.3A DC		95-2573					

SPEAKER

ITEM No.	TYPE				REPLACEMENT DATA			NOTES
					ZENITH PART No.	JENSEN PART No.	QUAM PART No.	
SP1	4" X 8"	PM	16Ω	49-1138			46A07UZ16	
SP2	4" X 8"	PM	16Ω	49-1138			46A07UZ16	

PHONO CARTRIDGE & NEEDLES

*NEEDLE LISTINGS SHOWN ARE FOR RESPECTIVE REPLACEMENT CARTRIDGES ONLY.

ITEM No.	REPLACEMENT DATA								NOTES
	ZENITH PART No.		ASTATIC PART No.		ELECTRO-VOICE PART No.		SONOTONE PART No.		
	CARTRIDGE	NEEDLE*	CARTRIDGE	NEEDLE*	CARTRIDGE	NEEDLE*	CARTRIDGE	NEEDLE*	
M1	142-148		142	N72*	148	2016*	19T2-S	N-19T2-7S* N-19T2-3S	Needle Replacement for Original Cartridge.
				N72		2123			

MISCELLANEOUS

ITEM No.	PART NAME	ZENITH PART No.	NOTES
M2	Motor	35447	Phono On Changer
S1	Switch		

WIRING DATA

General-use Unshielded Hook-up Wire Use BELDEN No. 8530 (Solid) Available in 12 Colors
8524 (Stranded) Available in 12 Colors
Power Cord Use BELDEN No. 17106 (Plastic) or 17126 (Rubber) - 6 Ft.
17109 (Plastic) or 17129 (Rubber) - 9 Ft.

PHOTOFACT® Folder



V-M MODELS

1236, 1237, 1285, 1287, 1295, 1297

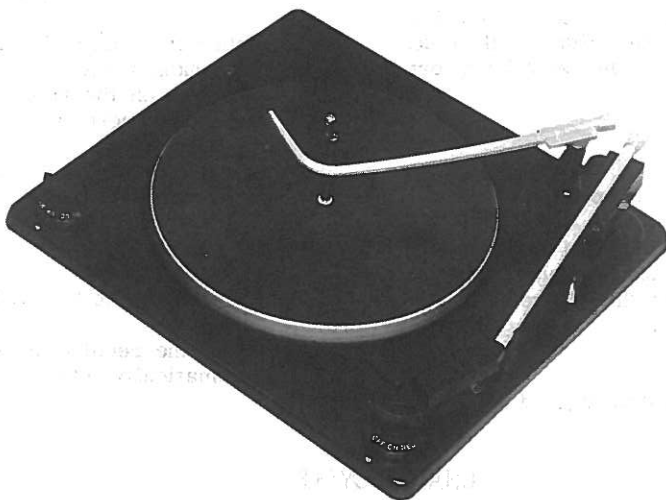

TRADE NAME: V-M Models 1236, 1237, 1285, 1287, 1295 and 1297

SUPPLIER: For Current Address, See Master Index.

TYPE SET: 4 Speed (16 2/3, 33 1/3, 45 and 78 rpm) Automatic Record Changer

POWER SUPPLY: 110-120 Volts AC

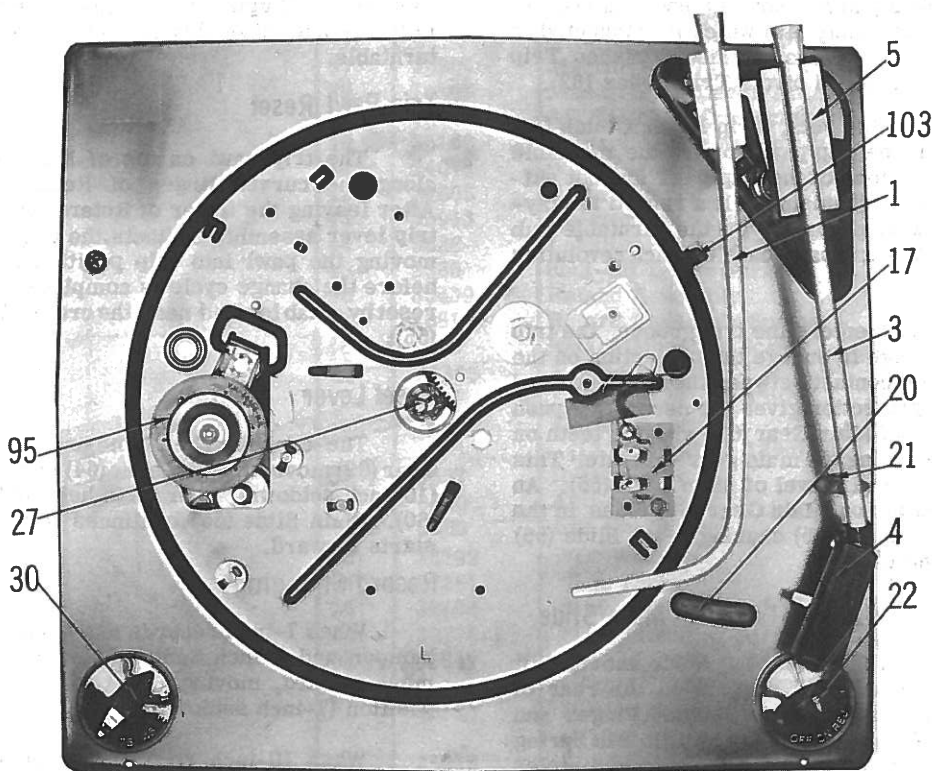

HOWARD W. SAMS & CO., INC. Indianapolis 6, Indiana



The listing of any available replacement part herein does not constitute in any case a recommendation, warranty or guaranty by Howard W. Sams & Co., Inc., as to the quality and suitability of such replacement part. The numbers of these parts have been compiled from information furnished to Howard W. Sams & Co., Inc., by the manufacturers of the particular type of replacement part listed. C818

Reproduction or use, without express permission, of editorial or pictorial content, in any manner, is prohibited. No patent liability is assumed with respect to the use of the information contained herein. © 1966 Howard W. Sams & Co., Inc., Indianapolis 6, Indiana. Printed in U. S. America

DATE 2 -66

SET 797 FOLDER 7

OPERATING INSTRUCTIONS

Loading

1. Lift Record Support Arm (1) until it clears the spindle, then swing it out over the pickup arm.
2. Place up to a 1/2-inch stack of records on the spindle and lower them to the offset shelf. Hold the records level and place the record support arm on top of the records.

Starting

1. Select the correct stylus and speed.
2. Rotate the Off/On/Rej knob to Rej and release. The changer will automatically play, change records, and shut off after the last record.

Rejecting

1. Rotate the On/Off/Rej knob to Rej and release.

Manual Operation

1. Lift Record Support Arm (1) and swing it fully to the right until a detent is felt.
2. Rotate the On/Off/Rej knob to Rej and release. The changer will cycle and the pickup arm will set down on the rest post. The turntable will continue to revolve.
3. Select the correct stylus and speed.
4. Place a record on the spindle and lower it to the turntable.
5. Carefully place the pickup arm on the record.
6. After the record has played, the pickup arm automatically returns to the rest post.

CHANGE CYCLE

These changers have a velocity trip mechanism, started by the faster inward motion of the pickup arm when the stylus enters the trip groove at the end of the record.

Rotate the turntable manually and observe the change cycle.

Tripping

When the pickup arm nears the end of a record, Finger and Shaft Assembly (49) which is connected to the pickup arm so they move in unison, pushes Trip Link (54) so it engages and pivots Trip Lever (82).

As Trip Lever (82) pivots, Trip Lever Clutch (81) pivots and carries the trip pawl toward the turntable hub. The small motions of the trip pawl are not sufficient to cycle the mechanism while a record is playing because the wiping contact by the turntable hub projection moves the trip pawl back on each revolution of the turntable.

When the stylus enters the trip groove, the trip pawl moves far enough to engage the projection on the turntable hub. The contact between the trip pawl and the turntable hub projection gives the necessary push to engage the teeth of Main Gear (69) with the teeth on the turntable hub causing the main gear to rotate. This action starts the lateral travel of Main Slide (55). An eccentric mounted pin on Main Gear (69) rides in the cross slot of Main Slide (55) causing Main Slide (55) to move toward the rear.

Pickup Arm Lift and Lateral Travel of Main Slide

When the Main Slide (55) begins to move, Lift Pin (9) rides up the inclined surface on the rear of Main Slide (55), raising the pickup arm. Finger and Shaft Assembly (49) is pushed up by Lift Pin Spring (52) at the same time, causing the two formed dimples in Finger and Shaft Assembly (49) to engage the two holes in Locator and Bushing Assembly (43) which controls the movement of the pickup arm during the change cycle.

Main Slide (55) continues its lateral travel from the spindle until the tab formed on the rear of the main slide pushes against Locator and Bushing Assembly (43), causing the pickup arm to move out over the rest post.

Record Drops

At this point a tab on the front of Main Slide (55) contacts Ejector Bracket Assembly (87) forcing Spindle Push Rod (77) upward and causing the record pusher in the spindle assembly to drop the next record to the turntable.

Trip Pawl Reset

The trip pawl on top of Main Gear (69) rides along the curved finger of Retard Assembly (46). After leaving the finger of Retard Assembly (46), the trip lever assembly contacts the trip link guide rivet, moving the pawl into trip position again. However, before the change cycle is completed, the trip pawl is reset by a tab located near the cross slot of Main Slide (55).

Reset Lever

The cam surface of the bracket on top of Main Gear (69) moves Reset Lever (64) into its mid-position (10-inch setdown), where it is held by 12-inch Selector (60). Main Slide (55) continues to the rear and then starts forward.

Record Changing

When 7-inch records are being changed, rubber bumper and 7-inch Setdown Lever (67) are free to move upward, moving Reset Lever (64) to the upper position (7-inch setdown).

When 10-inch records are being changed, the 7-inch lever cannot rise because the rubber bumper contacts the edge of the 10-inch record. Consequently, Reset Lever (64) remains in the mid-position as originally placed by the camming action of the bracket on top of Main Gear (69).

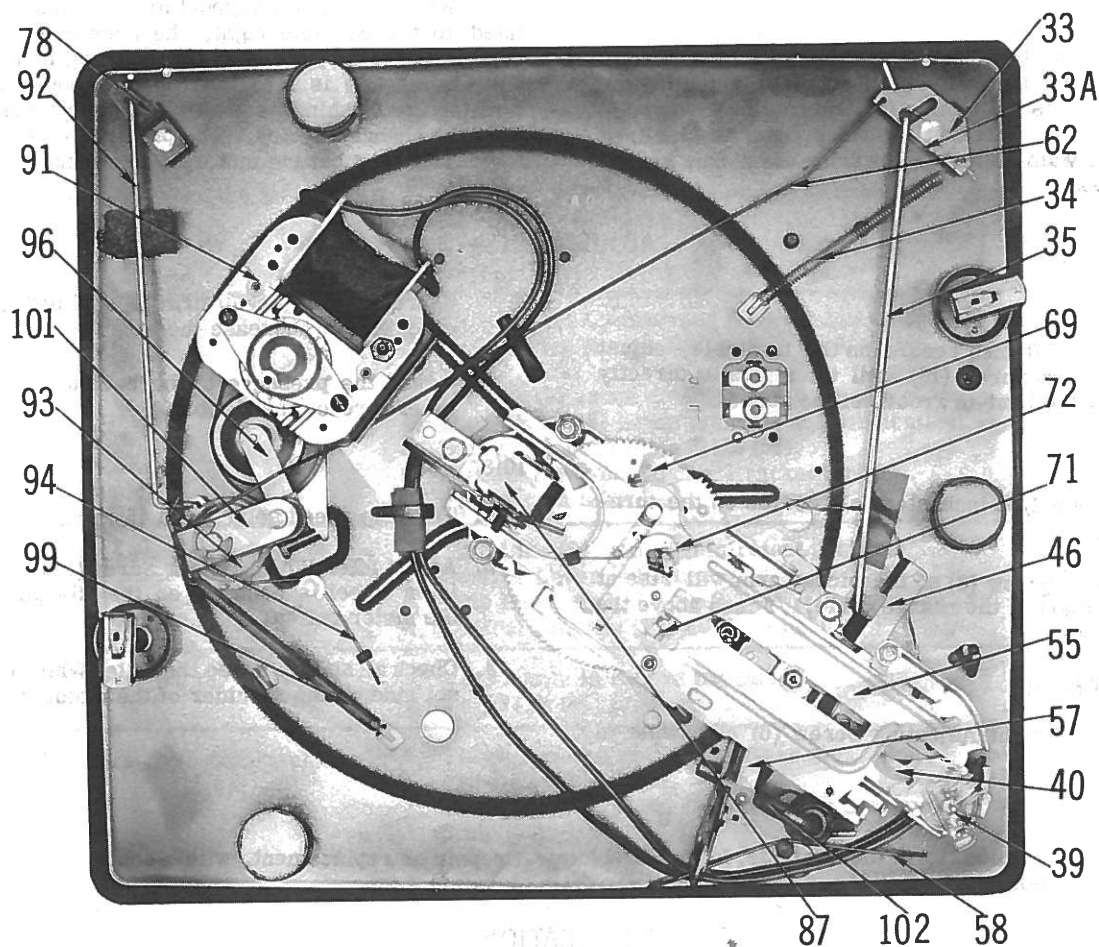

When 12-inch records are being changed, the record pivots 12-inch Record Selector (60) toward the rear of the changer causing the end of Reset Lever (64) to disengage from the edge of 12-inch Record Selector (60). This permits Reset Lever (64) to drop into the recess at the bottom of 12-inch Record Selector (60) and to engage the bottom step of Locator and Bushing Assembly (43), positioning the pickup arm for 12-inch setdown.

Pickup Arm Inward Movement

As Main Slide (55) continues its forward movement, the tab on the rear of Main Slide (55) moves clear of Locator and Bushing (43) and Finger and Shaft Assembly (49), which are locked together. This permits Return Spring (42) to move the pickup arm inward until one of the three set-down steps in Locator and Bushing Assembly (43) strikes Reset Lever (64) which stops the pickup arm above the lead-in groove of the record. The pickup arm is then lowered to the record as Lift Pin (9) rides down the incline on the rear of Main Slide (55). As the pressure is released from Lift Pin Spring (52), Locator and Bushing Assembly (43) and Finger and Shaft Assembly (49) separate. The pickup arm is now free to travel across the record.

Last Record Drops

When the last record drops to the turntable, Record Support Arm (1) drops below the spindle shelf and the lower end of Record Support Shaft (102) contacts the stop arm on Record Support Guide (57). The stop arm applies pressure to Shut-off Lever (68). Main Slide (55) is now in its outermost position and the end of Shut-off Lever (68) is forced against escape lever, preventing the Shut-off Lever (68) from lowering.

As Main Slide (55) moves to the out-of-cycle position, the end of Shut-off Lever (68) slides off the escape lever, permitting the end to extend through the slot in Main Slide (55). Locator and Bushing Assembly (43) has now rotated too far to be blocked by Shut-off Lever (68). The pickup arm is permitted to land on the record.

Automatic Shut-Off

After the last record has played, the mechanism goes into another change cycle. When Main Slide (55) reaches the outermost position, force applied to Shut-off Lever (68) from Record Support Arm Shaft (102) causes the end of Shut-off Lever (68) to extend through the slot in Main Slide (55). This same force causes the other end of Shut-off Lever (68) to raise and pre-

vent Locator and Bushing Assembly (43) from rotating. This action positions the pickup arm over the rest post.

As Main Slide (55) moves back toward the spindle, Trip Link (54) pushes Control Lever (40), actuating the AC switch. As Main Slide (55) returns to the out-of-cycle position, Lift Pin (9) rides down the inclined surface of Main Slide (55), lowering the pickup arm to the rest post.

Manual Play

When the record support arm is raised and rotated to the extreme right, the pressure placed on Shift Lever (37) by the shift lever spring is released. Shift Lever (37) is free to drop far enough to keep Locator and Bushing Assembly (43) from turning each time the changer cycles. The pickup arm will return to the rest post but the motor will continue to run.

ADJUSTMENTS

Setdown

1. With a 10-inch record on the turntable, adjust Set-down Screw (16) until the stylus is directly over the lead-in groove of the record.

decrease the pickup arm weight and counter-clockwise to increase the weight.

2. Adjust the pressure to the cartridge manufacturer's recommendations.

Height

1. Place a 1/2-inch stack of records on the turntable.
2. Adjust Screw (8) so the pickup arm will rise at the start of the change cycle, 1/8 inch above the stack.

Idler

1. Turn the speed selector to 45 rpm.
2. Adjust Idler Wheel Height Screw (101A) until the idler wheel is centered on the 45-rpm step of the motor pulley.
3. Check all speeds to see that Idler Wheel (95) does not ride on the shoulder of the motor pulley.

Stylus Pressure

1. Turn Weight Adjusting Screw (6) clockwise to

CLEANING

Clean the inside rim of the turntable, Idler Wheel (95), stepped motor pulley, and any part removed for

repair or replacement, with alcohol.

LUBRICATION

Lubricate only if the changer has extreme usage or if parts are replaced.

Apply a good-quality grease to the following:

1. Edges of all slots in Main Slide (55).
2. Outer edges of tines on forked end of Main Slide (55).
3. Lift pin cam surface on Main Slide (55).
4. Lower surface of Locator and Bushing Assembly (43).

5. Inner surface of tab on rear of Main Slide (55).

Apply one drop of a good-grade light motor oil to the following:

1. Finger and Shaft Assembly (49).
2. Push Rod (77)
3. Top and bottom motor bearings.

TROUBLE CHART

SYMPTOM	REMARKS
Off-On-Reject control cannot be turned to the On position.	1. Changer turned off during change cycle. Rotate the turntable clockwise to free mechanism.
Changer will not shut off after the last record has played.	1. Record Support Arm (1) does not drop below the spindle shelf. 2. Shut-off Lever (68) binding. 3. Shut-off bracket bent. 4. Tab on Main Slide (55) does not contact and rotate Locator (43) and Trip Link (54).
Turntable speed too slow.	1. Turntable bearing binding. 2. Low line voltage.

TROUBLE CHART (CONTINUED)

SYMPTOM	REMARKS
Changer noisy during change cycle.	<ol style="list-style-type: none"> 1. Tines on forked end of Main Slide (55) bent. 2. Ejector Lever (87) needs lubrication where it contacts Push Rod (79).
Changer shuts off when the last record drops to the turntable.	<ol style="list-style-type: none"> 1. Record Support Guide Assembly (57) bent. 2. Record Support Arm (1) bent. 3. Shut-off Lever Assembly (68) loose. 4. Escape Lever Spring (71) missing.
Pickup arm does not move smoothly.	<ol style="list-style-type: none"> 1. Pickup Arm Locator and Bushing Assembly (43) too tight. 2. Pickup Arm Return Spring (42) weak or connected to the wrong place. 3. Lift Pin (9) needs cleaning and lubricating. 4. Main Slide (55) needs cleaning and lubricating. 5. Burrs in slot of Main Slide (55). 6. Ejector lever on Ejector Bracket binding. 7. Pickup arm shaft and sleeve binding.
Changer cycles continuously.	<ol style="list-style-type: none"> 1. Trip Link (54) jammed in reject position. 2. Control Lever (40) binding. 3. Trip Pawl, Trip Lever (82), and Trip Lever Clutch (81) binding. 4. Control Linkage (35, 40) binding.
Changer trips before the end of the record.	<ol style="list-style-type: none"> 1. Center hole in record too large. 2. Trip Link (54) binding.
Turntable slows down during change cycle.	<ol style="list-style-type: none"> 1. Foreign matter in teeth of Gear (69), bent gear bearing, or spindle bushing bent. 2. Pickup Arm Lift Pin (9) binding on cam surface of Main Slide (55). 3. Defective motor. 4. Idler Wheel Tension Spring (99) weak or missing.
Changer will not cycle when the control is turned to reject.	<ol style="list-style-type: none"> 1. Control Shaft Assembly (40) does not move Trip Link (54) to the rear. 2. Trip Lever Clutch (81), Trip Lever Assembly (82) and trip pawl binding.
Noisy while playing.	<ol style="list-style-type: none"> 1. Motor grommets defective. 2. Motor rotor unbalanced. 3. Idler Wheel (95) has flat spots. 4. Turntable warped. 5. Idler mounting plate bent. 6. Lack of lubrication.
Turntable does not revolve.	<ol style="list-style-type: none"> 1. Defective AC switch. 2. Defective motor. 3. Idler assembly bent or binding. 4. Tension Spring (99) weak or missing. 5. Inside rim of turntable dirty or oily.
Pickup arm returns to rest post when in automatic play.	<ol style="list-style-type: none"> 1. Shift lever spring broken.
Record hits pickup arm.	<ol style="list-style-type: none"> 1. Pickup arm misadjusted. 2. Record finger, in Spindle (27), extends beyond the outside diameter. File the high points off so record will pass freely over spindle.
Two records drop at once.	<ol style="list-style-type: none"> 1. Center hole in record too large. 2. Spindle guide not fully down. 3. Spindle Set Screw (76) loose.
Changer repeats record in manual position.	<ol style="list-style-type: none"> 1. Shift Lever (37) or Shift Lever Pin (38) broken or bent. 2. Retaining screw loose.

V-M MODELS
1236, 1237, 1285, 1287, 1295, 1297

FOLDER 7

TROUBLE CHART (CONTINUED)

SYMPTOM	REMARKS
Stylus does not set down in lead-in groove of 7-inch record.	<ol style="list-style-type: none"> 1. 7-inch Set-down Lever Spring (66) weak, broken, or missing. 2. Pickup arm misadjusted. 3. 7-inch Set-down Lever Screw (65) loose. 4. 7-inch Set-down Lever (67) hitting frame or baseplate. 5. Reset Lever (64) bent. 6. 7-inch Set-down Lever (67) does not fall into opening in Main Gear (69). 7. Return Locator (43) bent. 8. Trip Finger Cam (49) bent.
Stylus does not set down in lead-in groove of a 12-inch record.	<ol style="list-style-type: none"> 1. Center hole of record too large. 2. Pickup arm misadjusted. 3. Pickup arm shaft and sleeve binding. 4. Reset Lever Spring (63) broken. 5. 12-inch Record Selector Spring (61) broken. 6. 12-inch Record Selector (60) binding. 7. Pickup Arm Return Locator (43) bent. 8. Trip Finger Cam (49) bent.
Stylus does not set down in the lead-in groove of 10-inch record.	<ol style="list-style-type: none"> 1. Pickup arm misadjusted. 2. Pickup arm shaft and sleeve binding. 3. 7- and 12-inch record selectors not operating properly. 4. Stylus bent. 5. 12-inch Record Selector Spring (61) broken. 6. Pickup arm return locator bent. 7. Trip Finger Cam (49) bent.
Stylus does not track properly.	<ol style="list-style-type: none"> 1. Stylus clogged with dust. 2. Trip Finger Cam (49) does not disengage from Pickup Arm Return Locator (43). 3. Pickup arm bearing binding. 4. Pickup leads too tight.
Record will not drop when changer cycles.	<ol style="list-style-type: none"> 1. Spindle Push Rod (77) bent. 2. Record finger in spindle does not move far enough. Spindle (27) should be replaced. 3. Ball Bearing (75) missing.
Changer will not cycle after playing a record.	<ol style="list-style-type: none"> 1. Trip pressure too great. (3 grams max.) 2. Damaged stylus. 3. No lead-out groove in record. 4. Pickup arm shaft and sleeve assembly binding. 5. Trip pawl binding on face of Main Gear (69). 6. Trip Finger Cam (49) bent. 7. Trip Link (54) bent.

MECHANICAL PARTS LIST

Ref. No.	Part No.	Description	Ref. No.	Part No.	Description
1	31507	Record Support Assembly	11	24240	Safety Spring
2	29224	Record Support Set Screw	12	4339	Safety Plate
3	31529	Tube & Counterweight Ass'y.	13	18723	Hinge Arm Assembly
4	33353	Cartridge Housing	14	31031	Pivot Button
5	33348	Carriage Assembly	15	31532-1	Pivot Button Screw
6	31531	Weight Adjusting Screw & Arm Assembly	16	31114	Set-Down Adjusting Screw
7	31533	Hinge Spring	17	18339	Phono Socket
8	33749-1	Height Adjusting Screw	18	2952	Fibre Washer
9	24445	Lift Pin (1237, 1287, & 1297)	19	26802	Phono Socket Mtg. Screw
	4327	Lift Pin (1236, 1285, & 1295)	20	23839	Needle Protector
10	14498	Keps Nut	21	31595	Rest Post (1237, 1287, & 1297)
				31597	Rest Post (1236, 1285, & 1295)

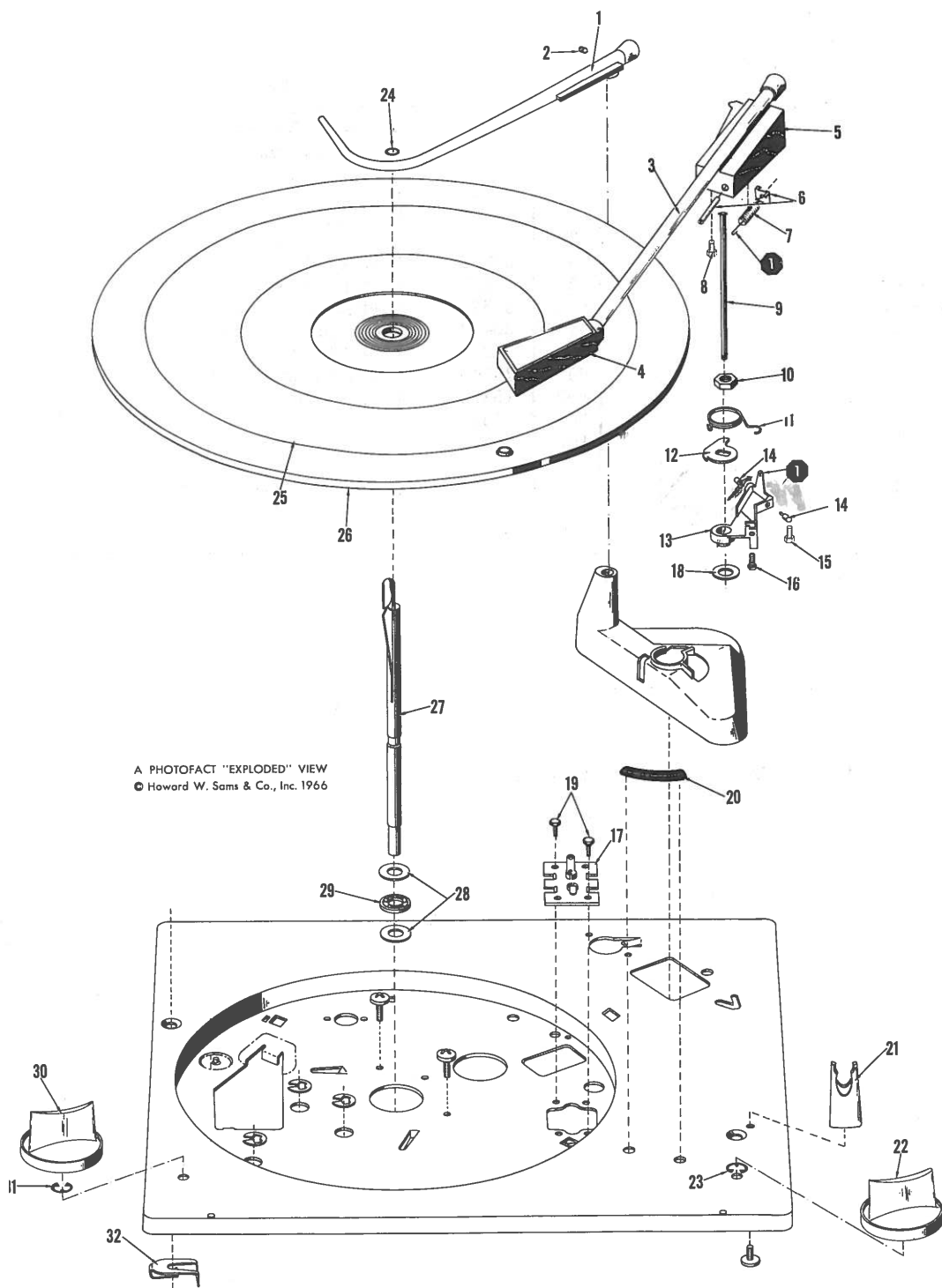

A PHOTOFAC "EXPLODED" VIEW
 © Howard W. Sams & Co., Inc. 1966

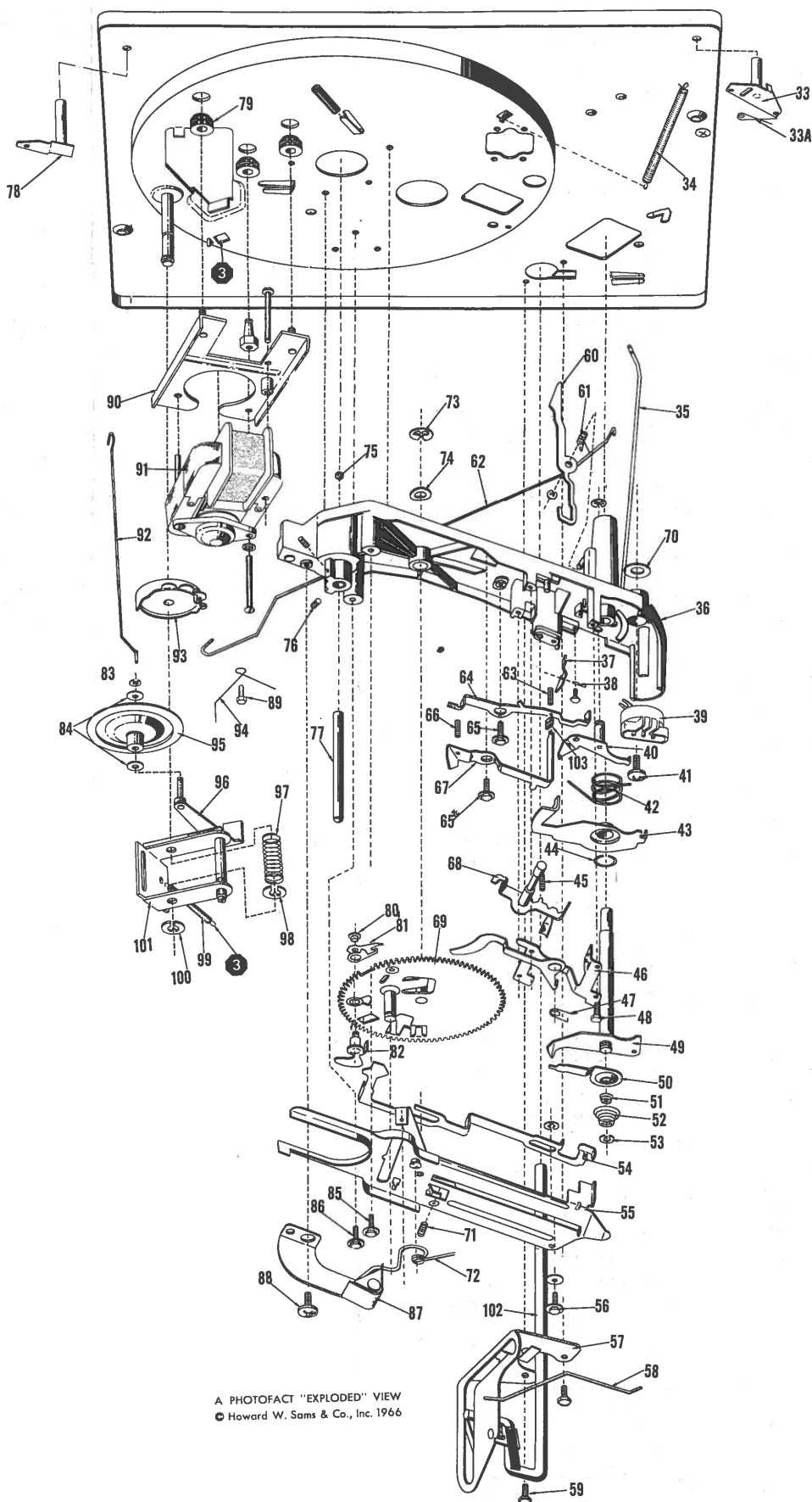

A PHOTOFACT "EXPLODED" VIEW
 © Howard W. Sams & Co., Inc. 1966

MECHANICAL PARTS LIST (Continued)

Ref. No.	Part No.	Description
22	29941	On-Off-Rej Knob.
23	16419	"E" Ring
24	21813-A	Turntable Retainer
25	30423	11" Turntable Mat
26	35531	9" Turntable Mat
		11" Turntable Assembly, Complete
	29053	9" Turntable Assembly
	23584	Inner Turntable Insert (11" Turntable only)
		Outer Turntable Insert (11" Turntable only)
	28285-B24	7" Button (11" Turntable only)
	21799	7" Button Spring (11" Turntable only)
	26599	Ramp (11" Turntable only)
27	25364	Spindle & Pusher Assembly (1237, 1287, & 1297)
	6049	Spindle & Pusher Assembly (1236, 1285, & 1295)
28	6877	Turntable Bearing Washer
29	6876	Turntable Bearing Retainer
30	29940	Speed Control Knob
31	16419	"E" Ring
32	22694	Mounting Bolt Clip
33	33812	Control Shaft Assembly
33A	33398	Control Spring
34	31350	Reject Spring
35	33715	Reject Rod
36	35437	Frame Assembly (1237, 1287, & 1297)
	35562	Frame Assembly (1236, 1285, & 1295)
37	16807	Manual Play Lever
38	16808	Manual Play Lever Pin
39	33945	AC Switch & Connector
40	35150	Control Lever Assembly
41	24073	Works Mounting Screw
42	24805	Return Spring
43	33943	Locator
44	5828	Locator Retaining Ring
45	2585	Shut-Off Lever Spring
46	35439	Retard Assembly
47	16817	Retard Assembly Spring
48	9849	Retard Mounting Screw
49	25365	Finger & Shaft (1237, 1287, & 1297)
	15450	Finger & Shaft (1236, 1285, & 1295)
50	9557	Retard Lever
51	9510	Anti-Skate Spring
52	9509	Lift Pin Spring
53	26792	"C" Washer
54	27261	Trip Link
55	35438	Slide Assembly
56	30778-2	Slide Mounting Screw
57	35547	Record Support Guide Ass'y. (1237, 1287, & 1297)
	35558	Record Support Guide Ass'y. (1236, 1285, & 1295)
58	25215	Wire Hold-Down Spring
59	25725-1	Guide & Spring Mtg. Screw
	4857	Guide Mounting Screw
60	24452	12" Record Selector (1237, 1287, & 1297)
	2957	12" Record Selector (1236, 1285, & 1295)

MECHANICAL PARTS LIST (Continued)

Ref. No.	Part No.	Description	Ref. No.	Part No.	Description
61	14951	12" Selector Spring	80	27144	Trip Lever Cap
62	27164	Retract Rod	81	33722	Trip Lever Clutch
63	24698	Reset Lever Spring	82	27149	Trip Lever
		(1295, & 1297)	83	24411	"E" Ring
	2925	Reset Lever Spring	84	3974	Idler Wheel Washer
		(1236, 1237, 1285, & 1287)	85	9849	Slide Mounting Screw
64	20886	Reset Lever	86	9849	Slide Mounting Screw
65	9849	Reset Lever Mounting Screw	87	35588	Ejector Bracket
66	35611	7" Lever Spring (1295 & 1297)	88	35578-7	Ejector Mounting Screw
	35612	7" Lever Spring (1236, 1237, 1285, & 1287)	89	29388	Detent Spring Shoulder Screw
67	30420	7" Lever (1295 & 1297)	90		Motor Support Bracket
	33652	7" Lever (1236, 1237, 1285, & 1287)	91	35447	Motor
68	35149	Shut-Off Lever	92	33992	Speed Control Rod
69	33811	Gear Assembly	93	30190	Speed Cam
70	2952	Fibre Washer	94	29376	Speed Cam Detent Spring
71	2585	Escape Lever Spring	95*	22915*	*Idler Wheel
72	27147	Detent Spring	96	35538	Idler Arm & Shaft Assembly
73	26796	"C" Washer	97	25432	Compression Spring
74	9762	Spring Washer	98	15212	"E" Ring
75	6884	Spindle Ball	99	35546	Idler Tension Spring
76	29224	Spindle Set Screw	100	15212	"E" Ring
77	33948	Push Rod (1237, 1287, & 1297)	101	35513	Yoke
	33947	Push Rod (1236, 1285, & 1295)	102	29378	Record Support Shaft
78	33989	Speed Control Shaft Assembly			1237, 1287, & 1297)
79	3489	Motor Mounting Grommets		25712	Record Support Shaft
					(1236, 1285, & 1295)
			103	30317	7" Lever Bumper

* Idler Wheel, WALSCO Part No. 1496-05

Note: When ordering parts,
quote the part number and
the color if the part is
color-finished.