

JVC DVD PLAYER

XV-N330B

XV-N332S

INSTRUCTIONS



EN
©2006 Victor Company of Japan, Limited
GNT0068-005A[EK]
0206KTC-MW-SC

Region code of DVD VIDEO
This player can play back DVD VIDEO discs whose region code numbers include "2."
Examples of playable DVD VIDEO discs:



The player's region code is printed on the rear of the player.
Note of Color system format
This player accommodates the PAL system, and also can play back discs recorded with NTSC system. (NTSC video signals are converted to a PAL signal and output.)

Supplied accessories
If anything is missing, consult your dealer immediately.
• Remote control (x 1)
• R6(SUM-3)/AA(15F) battery (x 2)

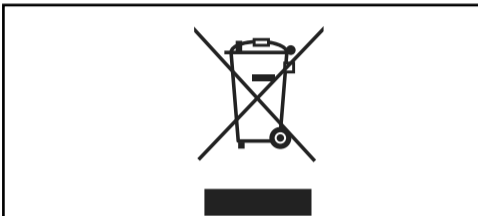

Information for Users on Disposal of Old Equipment [European Union Only]

This symbol indicates that product with this symbol should not be disposed as general household waste. If you want to dispose of this equipment, please do not use the ordinary dust bin! There is a separate collection System for these products.

Warnings, Cautions and Others

IMPORTANT for the U.K.
DO NOT cut off the mains plug from this equipment. If the plug fitted is not suitable for the power points in your home or the cable is too short to reach a power point, then obtain an appropriate safety approved extension lead or consult your dealer.
BE SURE to replace the fuse only with an identical approved type, as originally fitted.
If nonetheless the mains plug is cut off ensure to remove the fuse and dispose of the plug immediately, to avoid a possible shock hazard by inadvertent connection to the mains supply. If this product is not supplied fitted with a mains plug then follow the instructions given below.

IMPORTANT.
DO NOT make any connection to the terminal which is marked with the letter E or by the safety earth symbol or coloured green or green-and-yellow.
The wires in the mains lead on this product are coloured in accordance with the following code:
Blue : Neutral
Brown : Live
As these colours may not correspond with the coloured markings identifying the terminals in your plug proceed as follows:
The wire which is coloured blue must be connected to the terminal which is marked with the letter N or coloured black. The wire which is coloured brown must be connected to the terminal which is marked with the letter L or coloured red.

IF IN DOUBT - CONSULT A COMPETENT ELECTRICIAN.

CAUTION

To reduce the risk of electrical shocks, fire, etc.:

1. Do not remove screws, covers or cabinet.
2. Do not expose this appliance to rain or moisture.
3. The mains plug shall remain readily operable.

Caution — **STANDBY/ON button!**

Disconnect the mains plug to shut the power off completely. The **STANDBY/ON** button in any position does not disconnect the mains line. The power can be remote controlled.

IMPORTANT FOR LASER PRODUCTS

1. CLASS 1 LASER PRODUCT
2. **CAUTION:** Do not open the top cover. There are no user serviceable parts inside the unit; leave all servicing to qualified service personnel.
3. **CAUTION:** Visible and/or invisible class 1M laser radiation when open. Do not stare into beam or view directly with optical instruments.
4. REPRODUCTION OF LABEL: CAUTION LABEL, PLACED INSIDE THE UNIT.

CAUTION LASER RADIATION VISIBLE BEAM DO NOT STARE DO NOT VIEW DIRECTLY WITH OPTICAL INSTRUMENTS	ATTENTION RADIATION LASER VISIBLE BEAM NE PAS STARE NE PAS REGARDER DIRECTEMENT AVEC DES INSTRUMENTS OPTIQUES	ADVARSEL LASER RADIATION SYNLEGES BEAM DO IKKE STARE DO IKKE SE GJEDENLIGT GJEDENLIGT GJEDENLIGT GJEDENLIGT	ADVARSEL LASER RADIATION SYNLEGES BEAM DO IKKE STARE DO IKKE SE GJEDENLIGT GJEDENLIGT GJEDENLIGT GJEDENLIGT	VARO LASER RADIATION SYNLEGES BEAM ÄLÄ STARE ÄLÄ KATSO SUORAAN ÄLÄ KATSO SUORAAN SUORAAN SUORAAN	WARNING LASER RADIATION VISIBLE BEAM DO NOT STARE DO NOT VIEW DIRECTLY WITH OPTICAL INSTRUMENTS
---	--	---	---	---	---

5. This unit applies to the standard "IEC 60825-1: 2001" for laser products.

CAUTION:

- Do not block the ventilation openings or holes. (If the ventilation openings or holes are blocked by a newspaper or cloth, etc., the heat may not be able to get out.)
- Do not place any open flame sources, such as lighted candles, on the apparatus.
- When discarding batteries, environmental problems must be considered and local rules or laws governing the disposal of these batteries must be followed strictly.
- Do not expose this apparatus to rain, moisture, dripping or splashing and that no objects filled with liquids, such as vases, shall be placed on the apparatus.

Caution: Proper Ventilation

To avoid risk of electric shock and fire and to protect from damage, locate the apparatus as follows:

Front: No obstructions and open spacing.
Sides: No obstructions in 3 cm from the sides.
Top: No obstructions in 5 cm from the top.
Back: No obstructions in 15 cm from the back.
Bottom: No obstructions, place on the level surface.

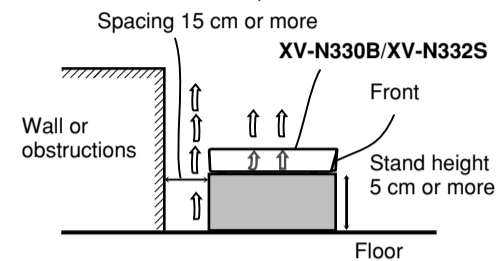

Precautions

Notes on the power cord

- When you are away on travel or otherwise for an extended period of time, remove the plug from the wall outlet. A small amount of power (1.0 W) is always consumed while the power cord is connected to the wall outlet.
- When unplugging the player from the wall outlet, always pull the plug, not the power cord.
- Do not handle the power cord with wet hands.
- Disconnect the power cord before cleaning the player or moving the player.
- Do not alter, twist or pull the power cord, or put anything heavy on it, which may cause fire, electric shock, or other accidents.
- If the cord is damaged, consult a dealer and have the power cord replaced with a new one.

Avoid moisture, water, dust, and high temperatures

- Do not place the player in moist or dusty places.
- If water gets inside the player, turn off the power and remove the plug from the wall outlet, then consult your dealer. Using the player in this state may cause a fire or electrical shock.
- Do not expose the player to direct sunlight or place it near a heating device.

Notes on installation

- Select a place which is level, dry and neither too hot nor too cold between 5°C and 35°C.
- Leave sufficient distance between the player and the TV.
- Do not install the player in a place subject to vibrations.
- Do not put heavy objects on the player.

To prevent malfunction of the player

- There are no user-serviceable parts inside. If anything goes wrong, unplug the power cord and consult your dealer.
- Do not insert any metallic objects, such as wires, hairpins, coins, etc. into the player.
- Do not block the vents. Blocking the vents may damage the player.

To clean the cabinet

- Use a soft cloth. Follow the relevant instructions on the use of chemically-coated cloths.
- Do not use benzene, thinner or other organic solvents and disinfectants. These may cause deformation or discoloring.

Playable discs

- DVD VIDEO, Audio CD, Video CD, SVCD



- DVD-R/-RW, +R/+RW written and finalized in the DVD VIDEO format
- CD-R/RW written in the SVCD, Video CD or Audio CD format
- CD-R/RW written in MP3/JPEG in accordance with the "ISO 9660" format

Supported Digital audio formats:

Linear PCM, MPEG Multichannel, Dolby Digital, DTS (Digital Theater Systems)*

NOTES

- If a disc gets dirty, scratched or warped, or due to the disc characteristics or recording conditions, the player may not be able to play back such discs.
- The player can play back audio signals recorded in MIX-MODE CD, CD-G, CD-EXTRA and CD TEXT.
- With some discs, operations may not be possible.
- * To play back DTS-encoded DVD VIDEO or DTS-encoded Audio CD discs correctly, connect the player to an amplifier with a built-in DTS decoder. Otherwise, playback sound will be distorted.

Unplayable discs

If you try to play back discs listed below, noise may be generated and causes damage to speakers.

- DVD-R/-RW written in the VR format
- DVD-ROM, DVD-RAM, DVD AUDIO, CD-ROM, PHOTO CD, SACD
- Unfinalized discs
- Discs of irregular shape or discs with tape, seals or paste on either the label side or playback side. Playing back these discs may damage the player.

The Non-DVD side of a "DualDisc" does not comply with the "Compact Disc Digital Audio" standard. Therefore, the use of Non-DVD side of a DualDisc on this product may not be recommended.

Connections

Before making connections:

- Do not connect the AC power cord until all other connections have been made.
- Connect VIDEO OUT of the player directly to the video input of your TV. Connecting VIDEO OUT of the player to a TV via a VCR/an integrated TV/Video system may cause a monitor problem.

Connecting to a TV with SCART connector

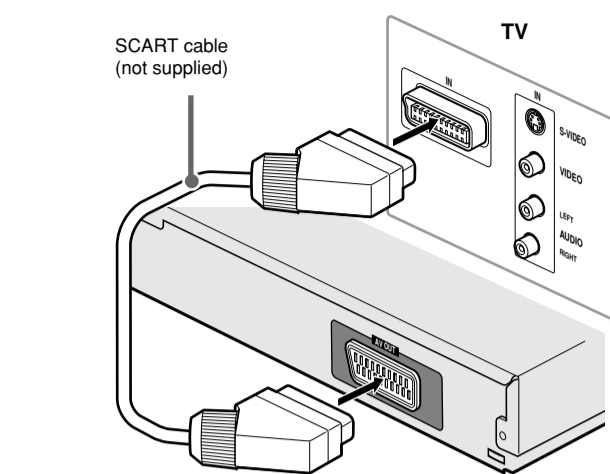

NOTE
The VIDEO jack, AV OUT terminal, and component (Y, Pb, Pr) jacks cannot be used at the same time.

Connecting to a TV with composite jacks

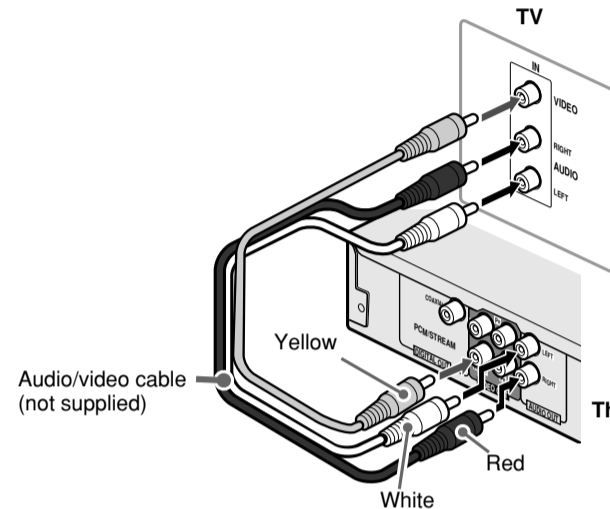

- NOTES**
- If your TV has a monaural audio input instead of stereo, use an optional audio cable which converts stereo audio output to monaural.
 - The VIDEO jack, AV OUT terminal, and component (Y, Pb, Pr) jacks cannot be used at the same time.

Connecting to a TV with component jacks

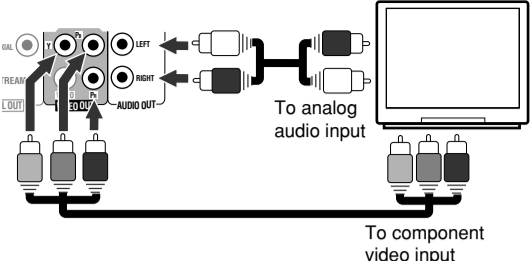

To switch the scanning mode between Progressive and Interlace, press and hold VFP-I/P on the remote control for a few seconds.

NOTES

- Connect to a TV with composite jacks and set [CONNECTIONS] to [VIDEO COMPONENT] before connecting with component jacks. (See "CONNECTIONS" in "Initial settings.")
- Connect "Y" to "Y," "Pb" to "Pb(Cb)," "Pr" to "Pr(Cr)" correctly.
- The VIDEO jack, AV OUT terminal, and component (Y, Pb, Pr) jacks cannot be used at the same time.

About the scanning mode indicator

[PICTURE SOURCE] of the PICTURE menu	Source type of DVD VIDEO	Video source
AUTO	[DDP]	[P]
FILM	[DDP]	[DDP]
VIDEO(NORMAL)/(ACTIVE)	[P]	[P]

NOTE

Some progressive TV and High-Definition TV sets are not fully compatible with the player. To check the compatibility of your TV, contact your local JVC customer service center.

Connecting to a stereo audio amplifier (receiver)

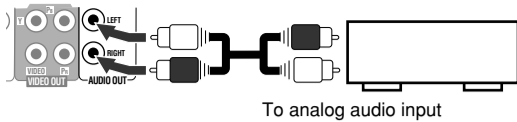

Connecting to a digital audio device

To enjoy high-quality surround sound, connect the DIGITAL OUT (COAXIAL) jack to a Dolby Digital or DTS decoder or an amplifier with a built-in decoder.

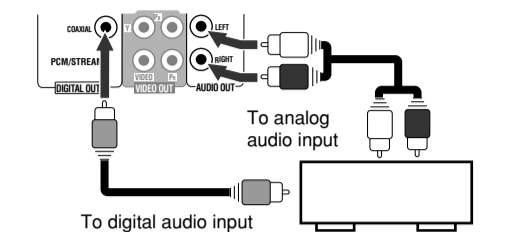

NOTES

- Depending on the disc, no signal may be outputted from the DIGITAL OUT. Make an analog connection in this case.
- Set [DIGITAL AUDIO OUTPUT] in the [AUDIO] preference display correctly according to the connected digital audio equipment. (See "DIGITAL AUDIO OUTPUT" in "Initial settings.")

Turning on the power

Inserting the AC power plug

After all other connections have been made, insert the AC power plug to the wall outlet firmly.

Installing the batteries in the remote control

Open the compartment cover, and place the two supplied R6(SUM-3)/AA(15F) batteries in the remote control according to the polarity markings ("+" and "-") inside the compartment. Then replace the cover.

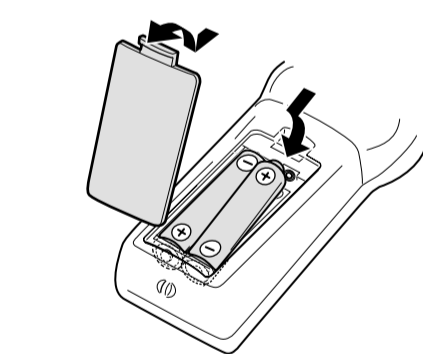

The batteries will last about six months with normal use. If the functions of the remote control become erratic, replace the batteries.

Precautions of the safe use of batteries

- Observe the following precautions for the safe use of batteries. If they are used improperly their lives will be shortened, they may burst or their contents may leak.
- Remove the batteries from the remote control if it is not going to be used for a long period of time.
- Remove dead batteries and dispose of them properly.
- Never leave dead batteries lying around, take them apart, mix them with other refuse, or throw them into an incinerator.
- Never touch liquid that has leaked out of a battery.
- Do not mix new and old batteries, or batteries of different types, when placing them.

Turning on and off the player

Press **STANDBY/ON**.

Initial setup

When you turn on the player for the first time after purchase, the following message appears on the TV screen.

EXECUTE DVD PLAYER SETUP? - BASIC PICTURE/AUDIO SETTING
YES - PRESS ENTER NO - PRESS CANCEL

Before enjoying this player, make the initial settings as follows:
1 Press ENTER.

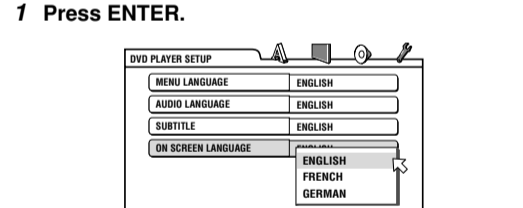

2 Press $\blacktriangle/\blacktriangledown$ to select the on-screen language for the preference displays, etc., then press ENTER.

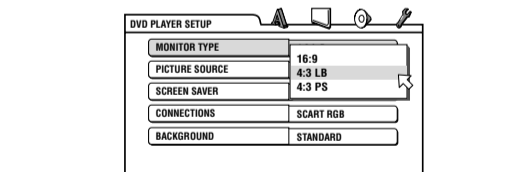

3 Press $\blacktriangle/\blacktriangledown$ to select the monitor type, then press ENTER.

- For a normal (conventional) TV, select "4:3 LB" or "4:3 PS." (See "MONITOR TYPE" in "Initial settings.")
- For a wide-screen TV, select "16:9."

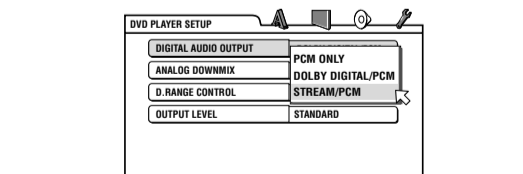

4 Press $\blacktriangle/\blacktriangledown$ to select a desired digital output signal type, then press ENTER.

- Set this item correctly according to the logo on your receiver or decoder. (If you do not connect the player to such a device, press ENTER to finish the setting.)
- Receiver/decoder bearing Dolby Digital logo and no DTS, select "DOLBY DIGITAL/PCM."
 - Receiver/decoder bearing both Dolby Digital and DTS logos, select "STREAM/PCM."
 - Receiver/decoder bearing neither Dolby Digital nor DTS logo, or digital recorder, select "PCM ONLY."

To bring up the DVD PLAYER SETUP display later
Press SET UP for a few seconds until the DVD PLAYER SETUP display appears.

Basic Operations

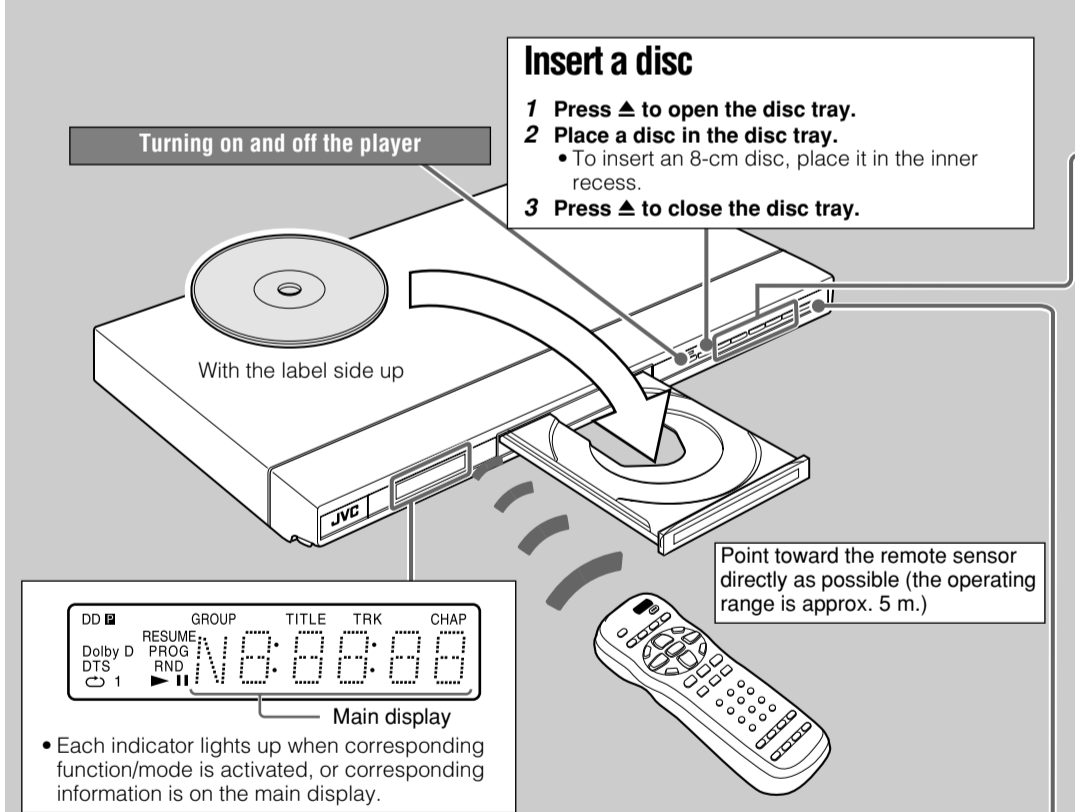

About On-screen guide icons

- ▶ : Playback.
- ⏸ : Pause.
- ⏮/⏭ : Slow-motion playback with the current speed.
- ⏮/⏭ : Fast forward/backward playback with the current speed.
- 👤 : At the beginning of a scene containing multi-angle views.
- 🔊 : At the beginning of a scene containing multi-audio sounds.
- 📄 : At the beginning of a scene containing multi-subtitles.

You can change the setting so that the on-screen guide icons do not appear on the TV screen. (See "ON SCREEN GUIDE" in "Initial settings.")

When playing a disc with low quality recording conditions or scratches

If the disc is poorly recorded or the disc is of poor quality, there may be problems with playback or discs cannot be played back at all. TRACK ADJUST function allows you to play back such discs with better quality. Each time you press TRACK ADJUST, the mode of the function appears on the TV screen and changes as follows:

- TRACK ADJUST OFF → TRACK ADJUST MODE 1 → TRACK ADJUST MODE 2**
Select TRACK ADJUST MODE 1 or MODE 2 which gives you better results.
To return to the normal playback mode, select TRACK ADJUST OFF.
- Opening the disc tray will set the function to off.
 - This function is not available for some discs.
 - If the disc cannot be played back, try to set the TRACK ADJUST mode before you close the tray.

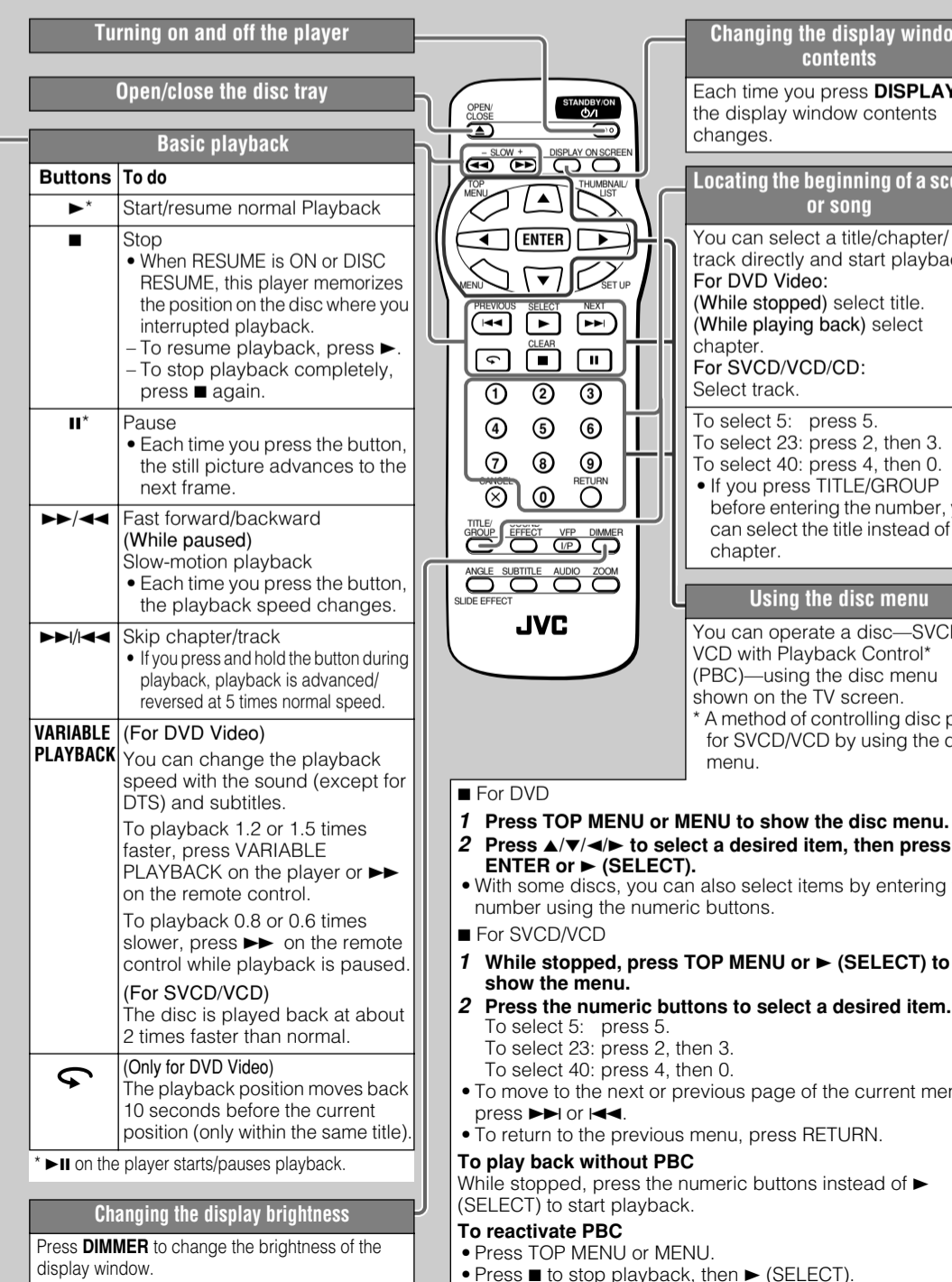

Advanced Operations

Changing the language, sound and scene angle

- 1 Press the button.
- 2 Press the button repeatedly or $\blacktriangle/\blacktriangledown$ to select the desired item.
- 3 Press ENTER to finish the setting.

Buttons	To do
AUDIO	For DVD Video: select audio languages. For SVCD/VCD: select the audio channel.
SUBTITLE	select the subtitle.
ANGLE	select the view-angle.

Changing the Sound Field

Each time you press **SOUND EFFECT**, the Sound Effect mode changes.
• As the value becomes bigger, the Sound Effect works stronger.

Zooming the picture

Each time you press **ZOOM**, the magnification changes.
• You can use $\blacktriangle/\blacktriangledown$ button to move the zoomed position.
To return to the normal playback, select the normal size by pressing **ZOOM** repeatedly.

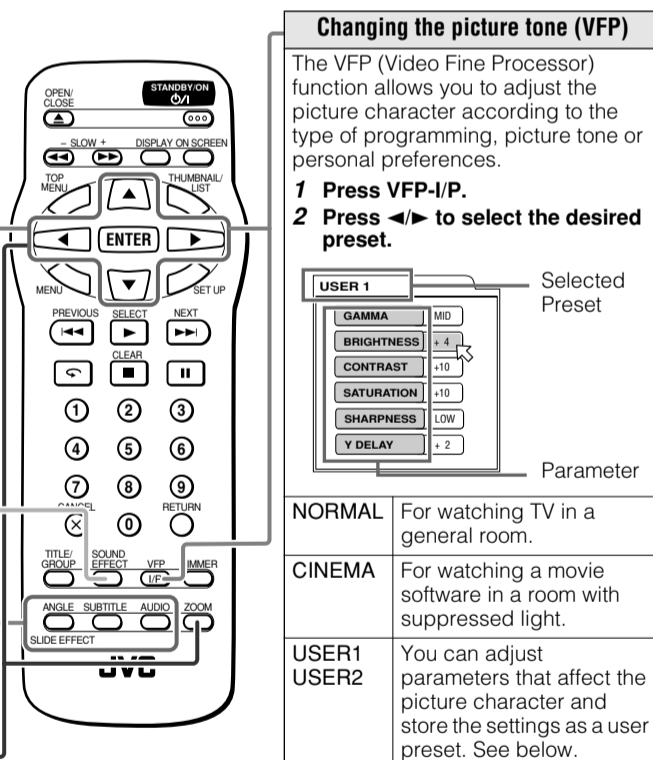

To adjust the picture tone	
1 Select "USER1" or "USER2."	
2 Press $\blacktriangle/\blacktriangledown$ to select a parameter, then press ENTER.	
GAMMA	Adjust this if the neutral color is bright or dark. The brightness of dark and bright portion is maintained (LOW/MID/HIGH).
BRIGHTNESS	Adjust this if the picture is bright or dark on the whole (-16 (darkest) to +16 (brightest)).
CONTRAST	Adjust this if the far and near position is unnatural (-12 to +12).
SATURATION	Adjust this if the picture is whitish or blackish (-16 (blackest) to +16 (whitest)).
SHARPNESS*	Adjust this if the picture is indistinct (LOW/HIGH).
Y DELAY	Adjust this if the picture looks separately/ overlapped (-2 to +2).

- 3 Press $\blacktriangle/\blacktriangledown$ to adjust the parameter, then press ENTER.
- 4 Repeat step 2 and 3 to adjust other parameters.
- 5 Press VFP-I/P to finish the setting.

Menu bar functions

You can use various functions from the menu bar.

To bring up the menu bar

When a disc is inserted, press ON SCREEN twice. A menu bar for the type of disc inserted will appear under the status bar.

Ex.: Menu bar for DVD VIDEO



To dismiss the menu bar and the status bar, press ON SCREEN.

Basic operation procedure

1 Press ◀▶ to select the icon you want to work with. 2 Press ENTER.

- After pressing ENTER:
 - (1) When a pull-down menu appears, press ▲/▼ to select the setting you want, then press ENTER.
 - (2) When a number-entry box appears, use the numeric buttons to enter the number you want, then press ENTER.
 - (3) When changing **TIME** setting, press ENTER repeatedly to select the setting you want.

NOTES

- The selected item on the menu bar is shown in green.
- The available functions differ depending on the player status. Refer to the explanation below to check when you can use a certain function.

Menu bar functions

- TIME** selects the time mode shown in the display window and the status bar.
- TOTAL:** Elapsed time of current title (DVD) or a disc (CD/VCD/SVCD).
- T.REM:** Remaining time of current title (DVD) or a disc (CD/VCD/SVCD).
- TIME:** Elapsed time of current chapter (DVD) or track (CD/VCD/SVCD).
- REM:** Remaining time of current chapter (DVD) or track (CD/VCD/SVCD) (while stopped, current track total time)

- REPEAT** selects repeat mode.

- DVD:** During playback
- CD:** In any condition
- VCD/SVCD:** In any condition except PBC playback
- CHAPTER:** Current chapter repeat (DVD)
- TITLE:** Current title repeat (DVD)
- TRACK:** Current track repeat (CD/VCD/SVCD)
- ALL:** All track repeat (CD/VCD/SVCD)
- A-B:** A-B repeat (During playback). After selecting A-B, press ENTER at the beginning point of repeat, then press ENTER again at the end point.

- OFF:** Repeat mode deactivated. Select this to quit repeat mode.
- TIME** specifies beginning point of a title (DVD) or a disc (CD/VCD/SVCD) by the time.
 - DVD: In any condition
 - CD: In any condition except program or random playback
 - VCD/SVCD: In any condition except PBC or program or random playback

- CHAP** selects a chapter to play back from (DVD only).

- OD** selects the audio language (DVD), sound track (DVD), or audio channel (VCD/SVCD) during playback.

- ST** selects the subtitle language (DVD) or subtitle (SVCD) during playback.

- SA** selects a desired scene angle in a multi-angle part (DVD only).

- PROG** specifies the playback order of tracks while stopped (unavailable for DVD). You can program up to 99 tracks.

- After selecting **PROG** icon, press the numeric buttons to specify tracks in the desired order.
 - To correct the program, press ▲/▼ to move to the track to be corrected, then press CANCEL. The track is erased and the subsequent programmed tracks move up.
 - Pressing **ALL** clears all the programmed tracks.
- Press ►(SELECT) to start program playback.**
 - During program playback, you cannot edit the program contents.
 - To exit the program mode, press ON SCREEN after clearing the program.

- RND** activates random playback while stopped (unavailable for DVD).
- After selecting **RND** icon, press ENTER. The player starts random playback.

Audio/Video files playback

You can play back MP3/JPEG files on a CD/CD-R/RW.

Precautions

- Use "ISO 9660" as the disc format.
- The player does not support "packet writing (UDF files)" discs.
- The player supports discs recorded with up to five multiple sessions.
- The player may be unable to play back a disc due to the characteristics or recording conditions.
- The player recognizes up to the fifth layer of groups, 999 files per group (including unplayable files), and up to 250 groups per disc.
- Add the appropriate extension (*.mp3 and *.jpg) to the file name.
- MP3i and MP3 Pro are not available.
- The player cannot play back a picture of more than 5120 x 3413 pixels (baseline JPEG) or 2048 x 1536 pixels (progressive JPEG).

Selecting a specific file or group

You can select files or folders (groups) using the Control display on the TV screen.

Control display

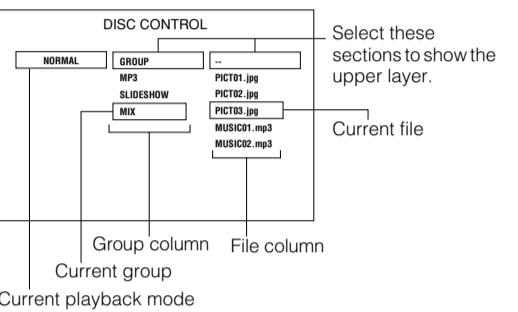

Press ▲/▼/◀▶ to move the cursor bar to a desired file, then press ►(SELECT).

- When you press ENTER, only the selected file is played back (except for MP3 files).

Various playback mode

- To play back a disc continuously, select NORMAL.

Repeat playback

- While stopped, press ▲/▼/◀▶ to move the cursor bar to playback mode.
- Press ENTER repeatedly to select the desired repeat mode.
 - REPEAT 1:** Repeats the current file.
 - REPEAT GROUP:** Repeats all files in the current group.
 - REPEAT ALL:** Repeats all files on the disc.
- Press ► to move the cursor bar to the file column, then press ►(SELECT).

Random playback

- While stopped, press ▲/▼/◀▶ to move the cursor bar to playback mode.
- Press ENTER repeatedly to select RANDOM.
- Press ► to move the cursor bar to the file column, then press ►(SELECT).

Program playback

- While stopped, press ▲/▼/◀▶ to move the cursor bar to playback mode.
- Press ENTER repeatedly to select PROGRAM.
- Press ▲/▼/◀▶ to select the desired file, then press ENTER.
- Repeat step 3 until all the desired files are selected.
 - To erase the last programmed file, press ◀ to move the cursor bar to the programmed files column, then press CANCEL.
- Press ►(SELECT).

Various JPEG files playback

To zoom in a picture

Press ZOOM. Each time you press ZOOM, you can magnify a JPEG file (x1.5/x2).

NOTE

This function is not available for some JPEG files depending on their resolution size and JPEG format.

To rotate/reflect a still picture

- While a still picture is played back:
 - Pressing ◀▶ rotates the picture by 90°.
 - Pressing ▲ reflects the picture vertically.
 - Pressing ▼ reflects the picture horizontally.

To select a JPEG file from the thumbnail list

- Press and hold THUMBNAIL/LIST while a JPEG file is selected on the Control display.
- Press ▲/▼/◀▶ to select the desired picture, then press ENTER.
 - You can change the page of thumbnail list by pressing ◀◀▶▶.

Slide show playback of JPEG files

- Press ►(SELECT) while a JPEG file is selected on the Control display.
- To select slide show effect
 - Press and hold ANGLE-SLIDE EFFECT until [SLIDE EFFECT MODE:] and the current mode appears on the TV screen.
 - By pressing and holding the button repeatedly, you can select the effect from 11 effects, random effect selection (RAND), and no effect (NONE). The effect is not applied to progressive JPEG files.

Initial settings

You can change the settings of this player according to your preferences and playing environment.

How to set the Initial settings

- Press SET UP.**
- Press ◀▶ to select the menu.**
- Press ▲/▼ to move to select the item.**
- Press ENTER.**
- Press ▲/▼ to select the options, then press ENTER.**

To dismiss a preference display
Press SET UP.

NOTES

- Some items in the menus cannot be changed during playback.
- During MP3 files playback, you cannot show the menus.
- If the upper and lower parts of the menu are cut off, adjust the picture size control of the TV.
- For settings of the LANGUAGE menu, see also "Language codes" below.
- Depending on the disc, the settings may not apply correctly.

LANGUAGE menu

Item	Contents
MENU LANGUAGE	You can select the default menu language of DVD VIDEO.
AUDIO LANGUAGE	You can select the default audio language of DVD VIDEO.
SUBTITLE	You can select the default subtitle language of DVD VIDEO.
ON SCREEN LANGUAGE	You can select "ENGLISH," "FRENCH," or "GERMAN" as the on-screen language.

PICTURE menu

Item	Contents
MONITOR TYPE <div><div>16:9</div><div>4:3 LB</div><div>4:3 PS</div></div>	You can select the monitor type to match your TV when you play back DVD VIDEO discs recorded for wide-screen televisions. [16:9] (Wide television screen): For a wide-screen (16:9) TV. [4:3 LB] (Letter Box conversion): For a normal (4:3) TV. Displays a wide-screen picture to fit the width of the TV screen keeping the aspect ratio. [4:3 PS] (Pan Scan conversion): For a normal (4:3) TV. The picture is zoomed up to filling the screen vertically and the left and right sides of the picture are cut off.
PICTURE SOURCE	You can obtain optimal picture quality by selecting the source type of the disc contents. [AUTO]: Normally, select this option. The player recognizes the picture type (film or video source) of the current disc according to the disc information. [FILM]: For a film source disc. [VIDEO (NORMAL)]: For a video source disc with relatively a few movements. [VIDEO (ACTIVE)]: For a video source disc with relatively a lot of movements.
SCREEN SAVER	You can set the screen saver function to ON or OFF.
CONNECTIONS	You need to select the video signal type when you connect the player to a TV with a SCART connector. [VIDEO COMPONENT]: A TV accommodates component signals. [SCART S-VIDEO]: A TV accommodates S-video (Y/C) signals. [SCART RGB]: A TV accommodates RGB signals. Note: If a TV accommodates composite signals, select [VIDEO COMPONENT] or [SCART RGB].
BACKGROUND	You can use your favorite image as the opening display. [STANDARD]: Display the JVC original image. [USER]: Display your favorite image as the opening display when a JPEG image is registered. [SAVE AS BACKGROUND]: To register a new image, select this while a JPEG image is displayed on the TV.

Specifications

Specifications

Specifications and appearance are subject to change without prior notice.

General

Readable discs:

DVD VIDEO, DVD-R/RW (Video format), +R/+RW (Video format), SVCD, Video CD, Audio CD (CD-DA), CD-R/RW (CD-DA, SVCD, Video CD, MP3 format, JPEG)

Video format: PAL, 625i/625p selectable

Other

Power requirements: AC 220 V ~ 240 V ~, 50 Hz/60 Hz
Power consumption: 11.0 W (POWER ON), 1.0 W (STANDBY mode)
Mass: 1.5 kg
Dimensions (W x H x D): 435 mm x 44 mm x 201.5 mm
Laser Specifications:
Wave length
CD: 790 ~ 805 mm
DVD: 650 ~ 660 mm
Output power
CD: 5 mW
DVD: 10 mW

Video outputs

VIDEO OUT (pin jack): 1.0 Vp-p (75 Ω)
RGB Output: 700 mVp-p (75 Ω)
Component (pin jacks)
Y Output: 1.0 Vp-p (75 Ω)
Pb/Pr Output: 0.7 Vp-p (75 Ω)
Horizontal resolution: 500 lines or more

Audio outputs

ANALOG OUT (pin jack): 2.0 Vrms (10 kΩ)
DIGITAL OUT (COAXIAL): 0.5 Vp-p (75 Ω termination)

Audio characteristics

Frequency response
CD (sampling frequency 44.1 kHz): 2 Hz to 20 kHz
DVD (sampling frequency 48 kHz): 2 Hz to 22 kHz(4 Hz to 20 kHz for DTS and Dolby Digital bitstream signals)
DVD (sampling frequency 96 kHz): 2 Hz to 44 kHz
Wow and flutter: Unmeasurable (less than ± 0.002%)

AUDIO menu

Item	Contents
DIGITAL AUDIO OUTPUT	Set this item correctly according to the logo on your receiver or decoder. [PCM ONLY]: Receiver/decoder bearing neither Dolby Digital nor DTS logo, or digital recorder. [DOLBY DIGITAL/PCM]: Receiver/decoder bearing Dolby Digital logo and no DTS. [STREAM/PCM]: Receiver/decoder bearing both Dolby Digital and DTS logos.
ANALOG DOWNMIX	Set this item properly according to your analog audio connection to play the sound of the surround multichannel audio on a DVD VIDEO. [DOLBY SURROUND]: Select this when connecting to a surround decoder. [STEREO]: Select this when connecting to a stereo amplifier or TV, or in case you want to record from a DVD VIDEO to a MiniDisc, cassette, etc.
D.RANGE CONTROL	Set this item to listen to DVD VIDEO recorded in Dolby Digital format at low or middle volume. [WIDE RANGE]: You can enjoy powerful playback sound. [NORMAL]: Normally, select this. [TV MODE]: Select this if the sound level of DVD VIDEO is lower than the one of TV program to make the sound at a lower volume clear.
OUTPUT LEVEL	Set this item to attenuate the level of the signal output from the analog AUDIO OUT terminals. If the sound from the speaker is distorted, select [LOW].

OTHERS menu

Item	Contents
RESUME	You can select the resume playback mode. [ON]: The player resumes playback from the position where playback has been stopped if the disc is still in the disc tray. [OFF]: This function is deactivated. [DISC RESUME]: The player resumes playback of the last 30 discs played. The player retains a memory of the stopped position of each disc even if the disc is removed from the disc tray. The TRACK ADJUST MODE selected for the disc will be resumed as well.
ON SCREEN GUIDE	Activate or deactivate the on-screen guide.
AUTO STANDBY	Set the time until the player turns off (into standby) automatically if playback is stopped for more than 30 minutes or 60 minutes.

SAFETY INSTRUCTIONS

“SOME DOS AND DON'TS ON THE SAFE USE OF EQUIPMENT”

This equipment has been designed and manufactured to meet international safety standards but, like any electrical equipment, care must be taken if you are to obtain the best results and safety is to be assured.

Do read the operating instructions before you attempt to use the equipment.

Do ensure that all electrical connections (including the mains plug, extension leads and interconnections between pieces of equipment) are properly made and in accordance with the manufacturer's instructions. Switch off and withdraw the mains plug when making or changing connections.

Do consult your dealer if you are ever in doubt about the installation, operation or safety of your equipment.

Do be careful with glass panels or doors on equipment.

DON'T continue to operate the equipment if you are in any doubt about it working normally, or if it is damaged in any way—switch off, withdraw the mains plug and consult your dealer.

DON'T remove any fixed cover as this may expose dangerous voltages.

DON'T leave equipment switched on when it is unattended unless it is specifically stated that it is designed for unattended operation or has a standby mode.

Switch off using the switch on the equipment and make sure that your family know how to do this.

Special arrangements may need to be made for infirm or handicapped people.

DON'T use equipment such as personal stereos or radios so that you are distracted from the requirements of traffic safety. It is illegal to watch television whilst driving.

DON'T listen to headphones at high volume as such use can permanently damage your hearing.

DON'T obstruct the ventilation of the equipment, for example with curtains or soft furnishings.

Overheating will cause damage and shorten the life of the equipment.

DON'T use makeshift stands and NEVER fix legs with wood screws — to ensure complete safety always fit the manufacturer's approved stand or legs with the fixings provided according to the instructions.

DON'T allow electrical equipment to be exposed to rain or moisture.

ABOVE ALL

—NEVER let anyone, especially children, push anything into holes, slots or any other opening in the case -this could result in a fatal electrical shock.;

—NEVER guess or take chances with electrical equipment of any kind -it is better to be safe than sorry!

Troubleshooting

Power

Power does not come on.

- Power plug is not inserted securely. Plug in securely.

Operation

“REGION CODE ERROR!” is shown on the TV.

- Region code of the inserted disc does not match the player. Check the region code of the disc printed on the disc jacket.

Operation is not possible.

- Microcomputer malfunction due to lightning or static electricity. Turn off the power and unplug the power cord, then connect the power cord again.
- Moisture condensation caused by a sudden change of temperature or humidity. Turn off the power, then turn it on a few hours later.
- The disc does not allow the operation, or an unplayable disc is inserted. Check and replace the disc.

[LOCK] is displayed on the display window and the disc tray does not open.

- When you press ▲ while pressing down ■ on the player in standby mode, the tray lock function is activated. The disc tray cannot be opened or closed in this status. To release this status, press ▲ while pressing down ■ on the player in standby mode.

Picture

Picture is noisy.

- The player is connected to a VCR directly and the copyguard function is activated. Connect the player so that the picture signal flows directly to the TV. With some discs, the picture may be blurred when [PICTURE SOURCE] is set to [FILM] or [AUTO]. Set [PICTURE SOURCE] to [VIDEO (NORMAL)] or [VIDEO (ACTIVE)].
- The disc may be poorly recorded or scratched. Try to use the **TRACK ADJUST** function to play back with better quality.

No picture is displayed on the TV screen or the screen is blurred or divided into two parts.

- The player is in the progressive scanning mode though it is connected to a TV via the VIDEO or SCART connector. Observe the display window. If [P] is turned on, the player is in the progressive scanning mode. Make the Progressive scanning mode inactive by using the VFP - I/P button.