

PHOTOFACT[®] with

CIRCUITRACE[®]

TRADE NAME : RCA Model YJH32W (Ch. TRT-5A)
 SUPPLIER : For Current Address, See Annual Index
 TYPE SET : 3-Speed, 2-Track, Monaural Recorder
 POWER SUPPLY : 110-120 Volts AC, 60 Cycles

This unit is a two-track, monaural recorder having three speeds: 1 7/8, 3 3/4, and 7 1/2 ips. Automatic recording level is provided.

Jacks are provided for both low- and high-level inputs, monitor output, and external speaker.

A power source of 110 - 120 volts AC, 60 cycles is required.

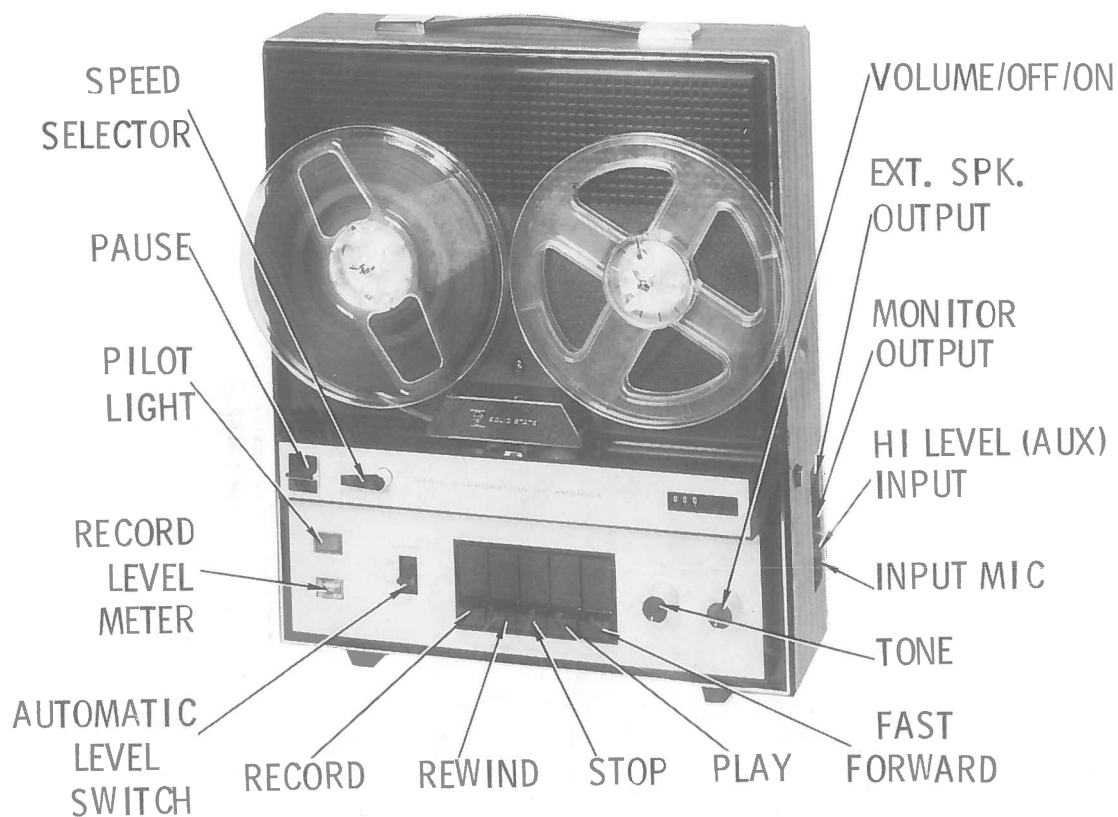

RCA MODEL YJH32W (Ch. TRT-5A)

HOWARD W. SAMS & CO., INC. Indianapolis, Indiana 46206

© 1968 Howard W. Sams & Co., Inc. Printed in U. S. of America C1015

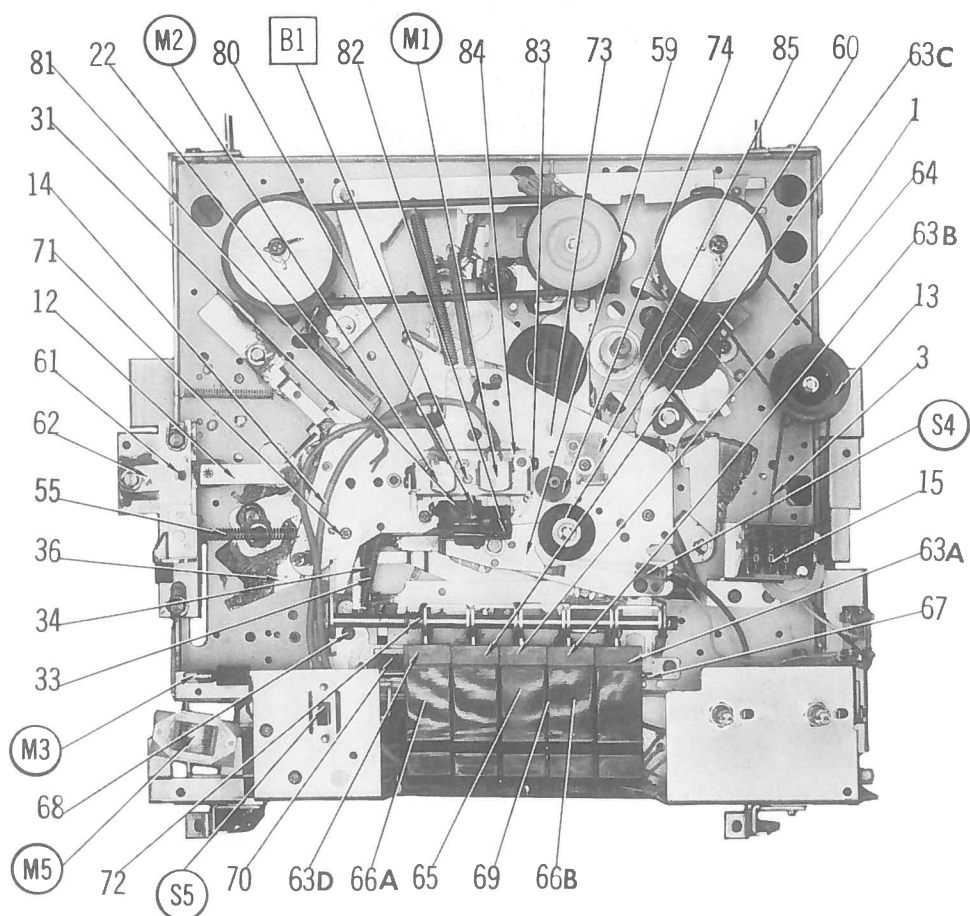
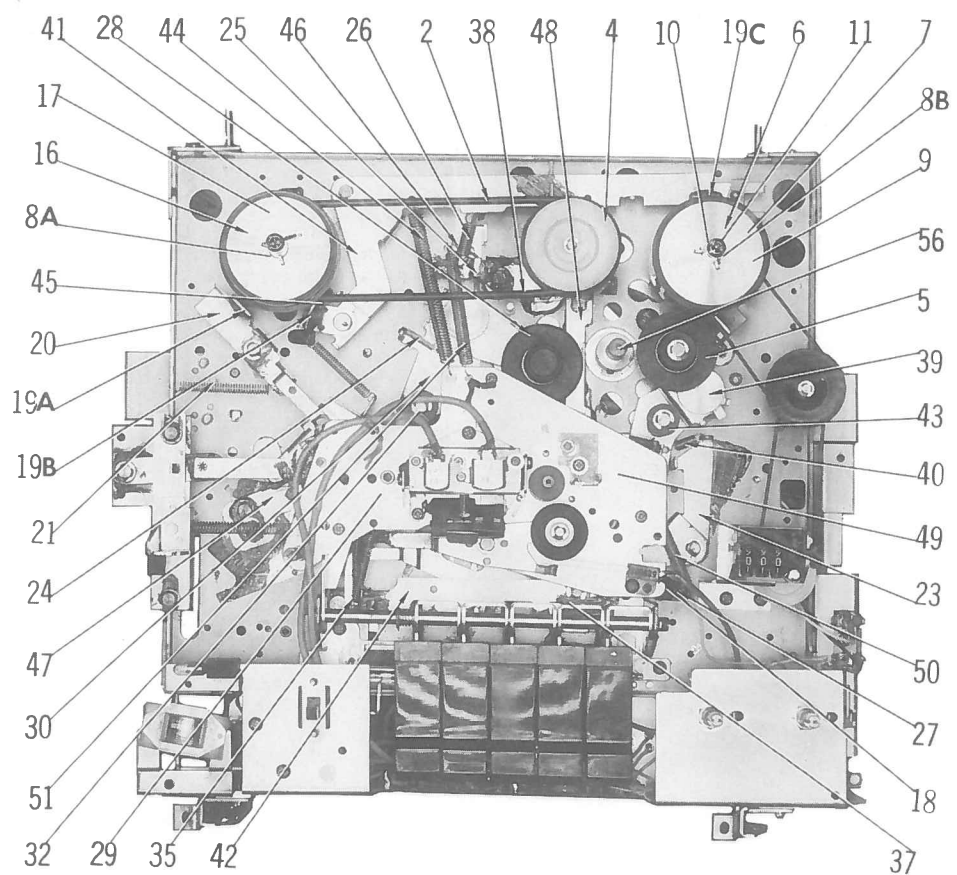

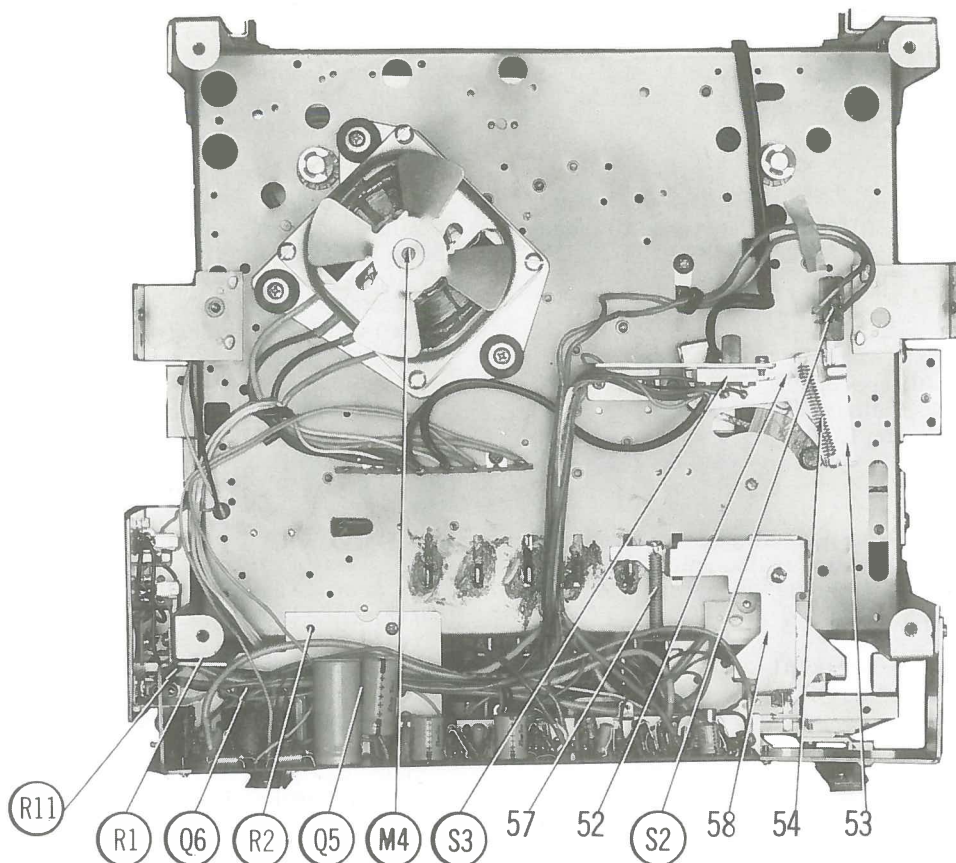

OPERATING INSTRUCTIONS

Record

1. Thread the tape, select the speed, and move Automatic Level switch to Off.
2. Connect a source to an input, press Record button, and set the recording level with Volume/Off/On control.
3. Press Stop button, press Play and Record buttons simultaneously, and record.

4. Move Automatic Level switch to On to limit maximum recording level.

Play

1. Repeat step 1 of "Record", move the speaker switch (in the accessory compartment) to On, press Play button, and adjust Volume and Tone controls as desired.

DISASSEMBLY

1. Remove four feet from back of cabinet, remove cabinet back, and disconnect speaker wires.
2. Remove four knobs, remove head cover, and remove Phillips screw from deck panel.
3. Remove two Phillips screws from sides of cabinet, remove four Phillips screws from feet on

bottom of cabinet, and remove two nuts holding handle to top of cabinet.

4. Remove two screws holding right cover lock, and remove cabinet shell.
5. Remove six Phillips screws holding mechanism to deck cover panel.

SEQUENCE OF OPERATION

Play

Pressing Play Push Button (63B), locked by Plate (70) and Spring (69), moves Slider (48) to pivot Arm (41), moving Pads (19B) and (19C) from Discs (17) and (7).

Slider (48) also pivots Arm (23) to pull Spring (40), pivoting Assembly (39) to press Wheel (5) against Shaft (56) and Pulley (9).

The motor — through Shaft (56), Wheel (5), Pulley (9), and Disc (7) — drives Spindle (6).

Push Button (63B) also pivots Arm (35) to pull Spring (29), pivoting Arm (30) to press Wheel (28) against Shaft (56) and Flywheel (73).

The motor, through Shaft (56) and Wheel (28), drives Flywheel (73).

Arm (35) also pulls Spring (34) to pivot Arm (59), pressing Roller (60) against Capstan (73) and actuating Switch (S4).

Arm (59) also releases Arm (81), pulled by Spring (80), to move Plate (82) against the heads.

Record

The Record sequence is the same as "Play", except Push Button (63D) is also depressed to cause Arm (58) to actuate Switch (S1).

Fast Forward

Pressing Fast Forward Push Button (63A), locked by Plate (70) and Spring (69), slides Plate (42), locking Push Buttons (63B) and (63D). Push Button (63A) also moves Slider (49) to move Slider (48), pivoting Arm (41) to move Pads (19B) and (19C) from Discs (17) and (7).

Slider (49) also lifts Assembly (39) to lift Wheel (5), and Slider (48) pivots Arm (23) to pull Spring (40). Spring (40) pivots Assembly (39) to press Wheel (5) against Shaft (56) and Disc (7).

The motor — through Shaft (56), Wheel (5), and Disc (7) — drives Spindle (6).

Rewind

Pressing Rewind Push Button (63C), locked by Plate (70) and Spring (69), slides Plate (42), locking Push Buttons (63B) and (63D). Push Button (63C) also moves Slider (46) to pivot Arm (41), moving Pads (19B) and (19C) from Discs (17) and (7).

Slider (46) also pulls Spring (26) to pivot Arm (25), pivoting Arm (38) to press Pulley (4) against Shaft (56).

The motor — through Shaft (56), Pulley (4), Belt (2), and Disc (17) — drives Spindle (16).

Stop

Pressing Stop Push Button (64) pivots Plate (70) to release any depressed button and to allow Springs (66B), (44), (18), (40), (33), (34), (24), and (45), plus (57) in Record to reverse the sequence of "Play". Springs (44), (50), (18), (40), (43), and (45) reverse "Fast Forward". Springs (44), (45), (51), and (26) reverse "Rewind".

Pause (From Play)

Moving the Pause button moves Slide (61) to pivot Lever (62), pivoting Arm (12) to release Arm (20), pulled by Spring (21), pressing Pad (19A) against Disc (17).

Arm (12) also pivots Arm (59) to move Roller (60) from the capstan.

Speed Change (From 7 1/2 to 3 3/4 IPS)

Moving the Speed Selector knob rotates Cam (36), locked by Arm (31) and Spring (22), to cause Arm (31) to pivot Arm (30), moving Wheel (28) from Flywheel (73). As Wheel (28) moves, Cam (36) moves Slider (47) to lift Arm (31), lifting Wheel (28).

TROUBLE CHART

IMPORTANT: Before consulting this chart be sure all servicing procedures listed on page 4 have been followed.

SYMPTOM	REMARKS
Take-up reel revolves erratically, or not at all in Play or Record	<ol style="list-style-type: none"> 1. Disc (7) worn or dirty. 2. Spindle (6) binding. 3. Wheel (5) worn, dirty, or binding. 4. Assembly (39) binding.
Take-up reel does not revolve in Fast Forward.	<ol style="list-style-type: none"> 1. Disc (7) worn or dirty. 2. Wheel (5) worn, dirty, or binding. 3. Assembly (39) binding.
Supply reel does not revolve in Rewind.	<ol style="list-style-type: none"> 1. Belt (2) worn, dirty, or broken. 2. Pulley (4) worn, dirty, or binding. 3. Spindle (16) binding. 4. Disc (17) worn or dirty.
Take-up reel spills tape in Rewind.	<ol style="list-style-type: none"> 1. Belt (1) broken.
Reels do not stop immediately when Stop button is pressed.	<ol style="list-style-type: none"> 1. Pads (19B) and (19C) worn or dirty. 2. Arm (41) bent or binding. 3. Spring (45) missing.
Capstan does not rotate in Play or Record.	<ol style="list-style-type: none"> 1. Wheel (28) worn, dirty, or binding. 2. Bearing (74) binding. 3. Arm (39) binding. 4. Motor defective or not supplied with power.

TROUBLE CHART (Continued)

SYMPTOM	REMARKS
Tape rides up and down between capstan and pressure roller.	1. Roller (60) worn. 2. Excessive take-up torque.
Wow or Flutter.	1. Roller (60) worn, dirty, or binding. 2. Wheel (28) dirty or worn. 3. Flywheel (73) binding. 4. Motor defective. 5. Excessive take-up torque.
Sound is weak or distorted.	1. Head (M1) dirty, misadjusted, or defective. 2. Amp defective. 3. Bias Oscillator defective. 4. Pad on Plate (82) defective.
Erase weak or inoperative.	1. Head (M2) dirty or defective. 2. Inadequate erase current. 3. Pad on Plate (82) defective.

ADJUSTMENTS

IMPORTANT: Before making any adjustments, refer to "General Servicing Information" on page 4.

1. All voltage measurements are made at a tape speed of 7 1/2 ips with an audio VTVM having a flat response to 100KC.
2. All torque measurements are made at a tape speed of 7 1/2 ips with a spring scale applied to a point on an empty tape reel 2 inches from reel center.
3. All pressure measurements are made by using a spring scale to determine that point at which pressure is just removed.

ADJUST	REMARKS
Play Take-up Torque	Nominal value 1 1/4 ounces. Controlled by condition of felt on Disc (7) and tension of Spring (10).
Fast Forward Take-up Torque	Nominal value 6 ounces. Controlled by condition of Wheel (5).
Rewind Torque	Nominal value 5 ounces. Controlled by condition of Belt (2).
Supply Reel Drag	Nominal value 1/4 ounce. Controlled by drag of Belt (2) and Pulley (4).
Take-up Reel Drag	Nominal value 1/4 ounce. Controlled by drag of Belts (1) and (3).
Pressure Roller Pressure	Nominal value 2 1/2 pounds. Controlled by tension of Spring (34).
Brake Torque	Measured in Stop. MINIMUM value (with Pad (19B) held against its stop) 7 ounces counterclockwise on supply reel. MINIMUM value 4 ounces clockwise on take-up reel. Controlled by condition of Pads (19B) and (19C).
Pause Brake Torque	Measured in Play. MINIMUM value 8 ounces counterclockwise on supply reel. Controlled by condition of Pad (19A).
Pressure Pad Pressure	Nominal value 1 3/4 ounces. Controlled by tension of Spring (80).
Erase Head Height	No adjustment provided.
Erase Head Azimuth	No adjustment provided.
Record/ Play Head Height	No adjustment provided.
Record/ Play Head Azimuth	Connect an AC VTVM across left output. Play an Azimuth test tape and adjust B1 for maximum output.
Erase Current	Nominal current 9.2ma (75Vrms) in head. No adjustment provided.

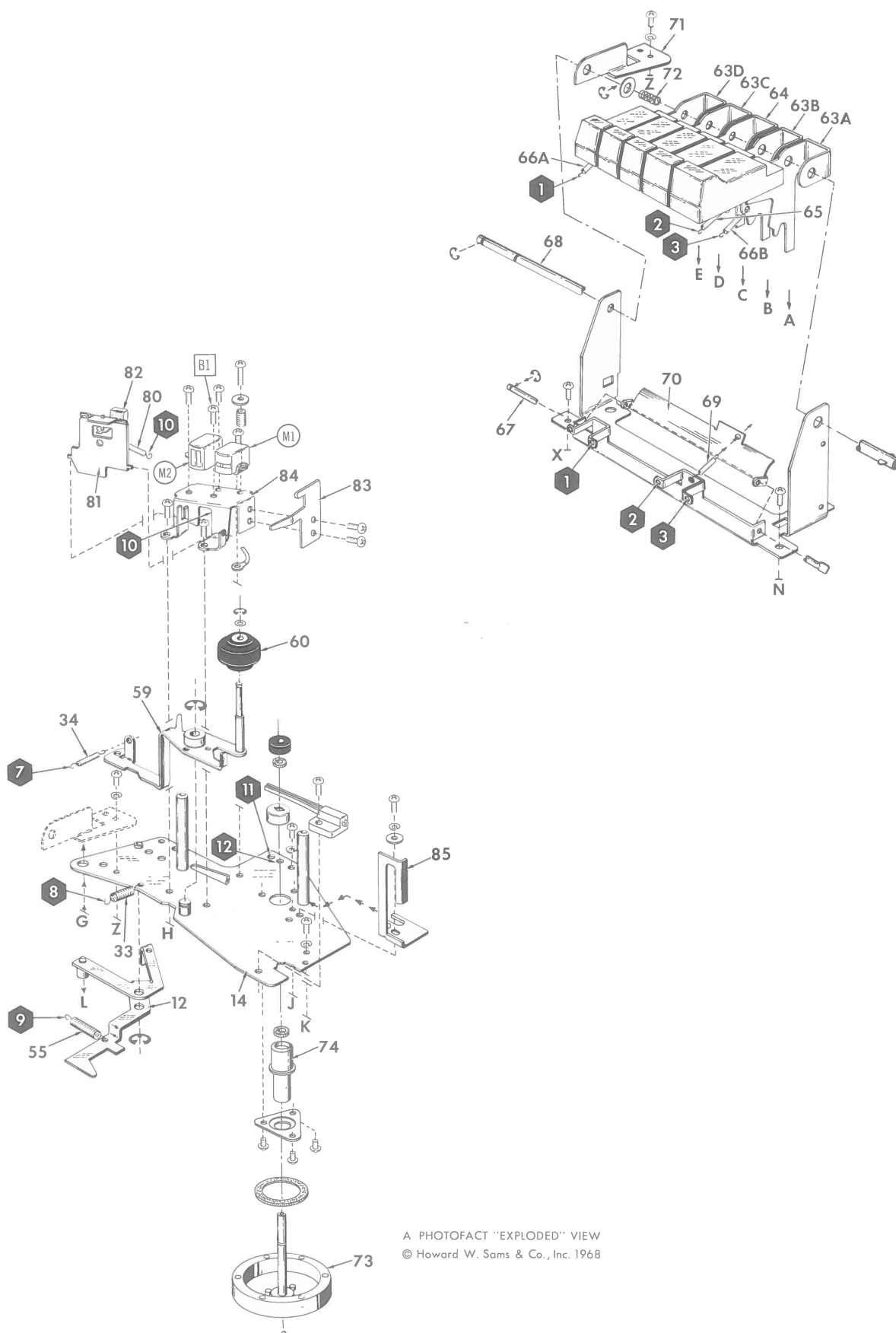

A PHOTOFAC "EXPLODED" VIEW
 © Howard W. Sams & Co., Inc. 1968

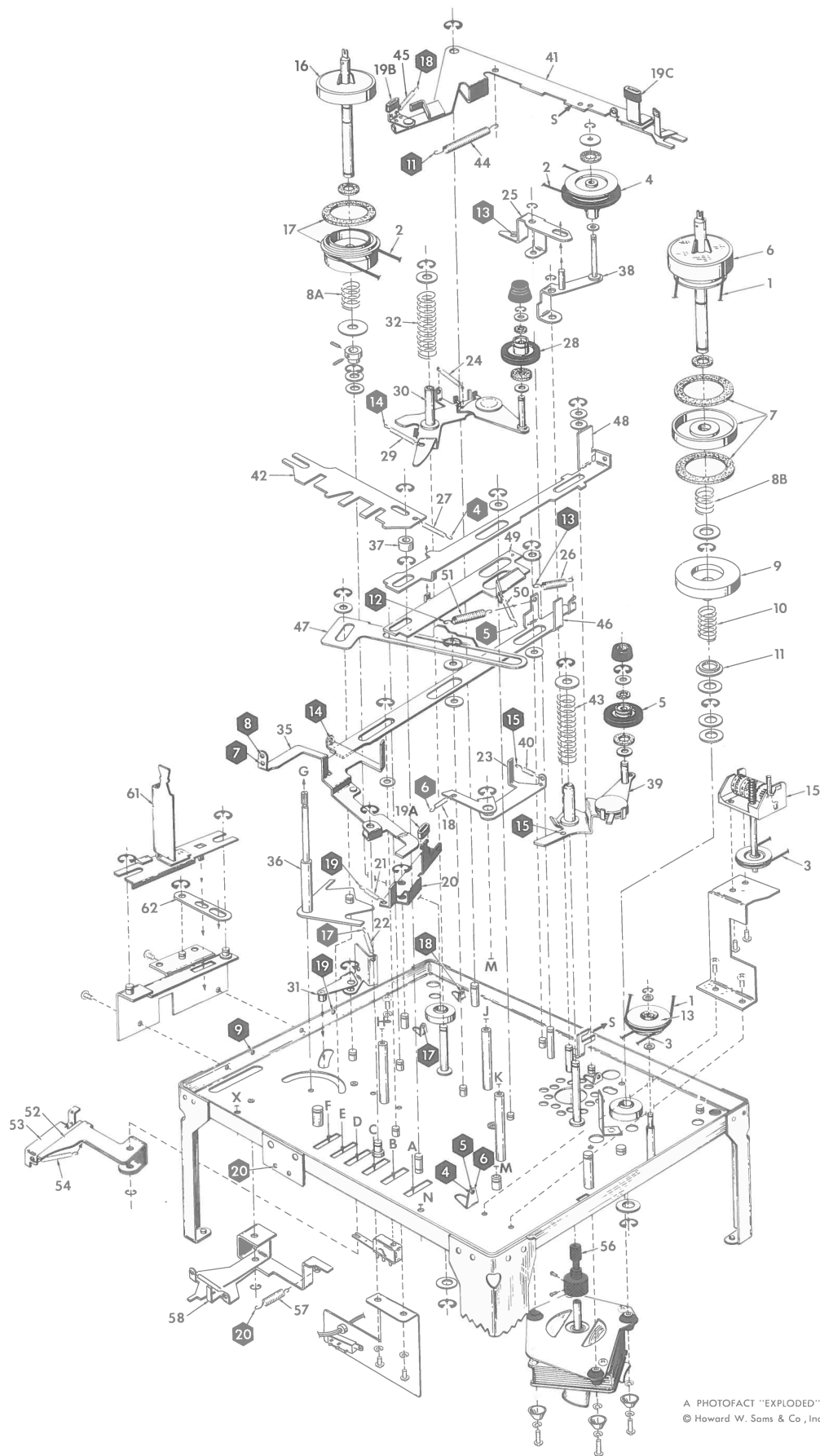

A PHOTOFACT "EXPLODED" VIEW
© Howard W. Sams & Co., Inc 1968

ADJUSTMENTS (Continued)

ADJUST	REMARKS
Record Bias	Nominal bias 54Vrms (.86ma) across head. Controlled by setting of R3.
Bias Oscillator	Nominal frequency 60KC. No adjustment provided.
Record Level Indicator Calibration	Select record function with Automatic Level switch off. Apply a 1000-cycle tone at .001Vrms to Mic Input. Adjust Volume for .88Vrms across Head (M1). Adjust R4 for normal maximum on Record Level Meter. Move Automatic Level switch to on. Voltage across head should drop to .71Vrms.

CLEANING

LUBRICATING

HEAD DEMAGNETIZING

Refer to "General Servicing Information" on page 4.

MECHANICAL PARTS LIST

Ref. No.	Part No.	Description	Ref. No.	Part No.	Description
1*	123586*	Counter Pulley Belt*	41	123556	Brake Arm
2	123587	Rewind Belt	42	123558	Push-button Plate
3*	123586	Counter Pulley Belt*	43	123593	Compression Spring
4	123555	Rewind Pulley	44	123606	Tension Spring
5	123542	Take-up Idler Wheel	45	123605	Tension Spring
6	123582	Take-up Spindle Assembly	46	123537	Rewind Slider
7	123581	Friction Disc	47	123540	Speed Selector Slider
8	123623	Compression Spring (2 used)	48	123529	Play and Fast Forward Slider
9	123579	Take-up Pulley	49	123528	Fast Forward Slider
10	123624	Compression Spring	50	123592	Tension Spring
11	123580	Collar	51		Tension Spring
12	123675	Pause Arm	52	123525	Compensation Switch Arm
13	123585	Tape Counter Pulley	53	123526	Compensation Switch Arm
14		Head Mounting Plate	54	123524	Tension Spring
15	123561	Tape Counter	55	123618	Tension Spring
16	123584	Supply Spindle Assembly	56	123534	Drive Shaft
17	123583	Supply Reel Disc	57	123524	Tension Spring
18	123596	Tension Spring	58	123664	Record Arm
19	123557	Rubber Brake Pad	59	123566	Pressure Roller Arm
20	123560	Pause Arm	60	123588	Pressure Roller
21	123610	Tension Spring	61		Pause Slide
22	123598	Tension Spring	62	123680	Pause Lever
23	123548	Arm	63	123677	Push Button (4 used)
24	123599	Tension Spring	64	123678	Stop Push Button
25	123554	Rewind Arm	65	123620	Tension Spring
26	120603	Tension Spring	66	123619	Tension Spring
27	123607	Tension Spring	67	123573	Lock Pin
28	123549	Capstan Idler Wheel	68	123575	Push-button Shaft
29	123602	Tension Spring	69	123619	Tension Spring
30	123552	Capstan Idler Arm	70	123574	Push-button Plate
31	123539	Speed Selector Cam Arm	71		Mounting Bracket
32	123601	Compression Spring	72	123679	Compression Spring
33	123598	Tension Spring	73	123562	Flywheel and Capstan
34	123617	Tension Spring	74	123564	Capstan Bearing
35	123538	Actuator Arm	80		Tape Pad Tension Spring
36	123676	Speed Select Cam	81		Tape Pad Arm
37	123559	Spacer	82		Tape Pad Plate
38	123553	Rewind Pulley Arm	83		Tape Guide
39	123547	Take-up Idler Arm Assembly	84		Head Mounting Plate
40	123595	Tension Spring	85		Automatic Shut-off Guide

* Counter Pulley Belt-WALSCO Part Number 1410-63.

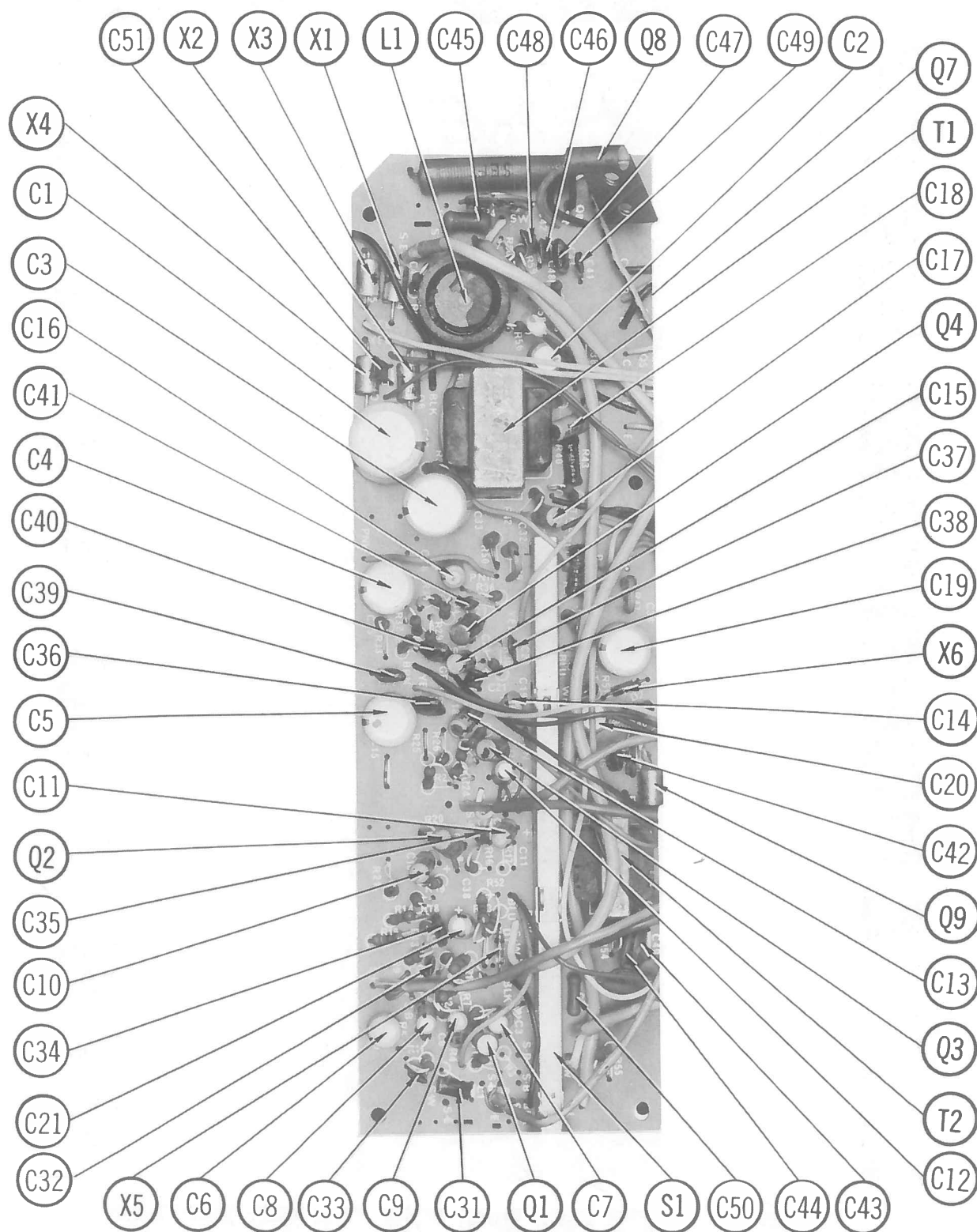

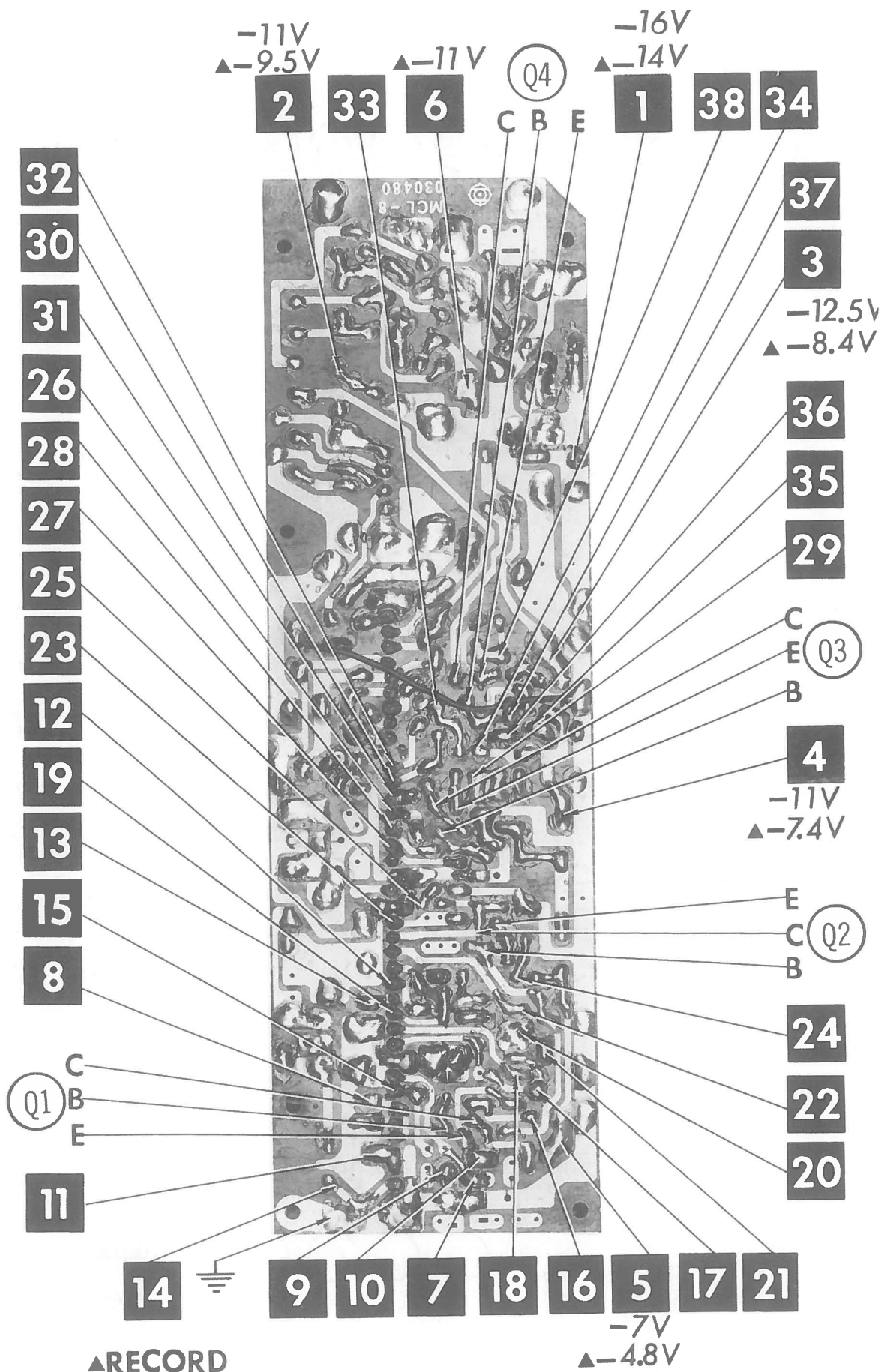

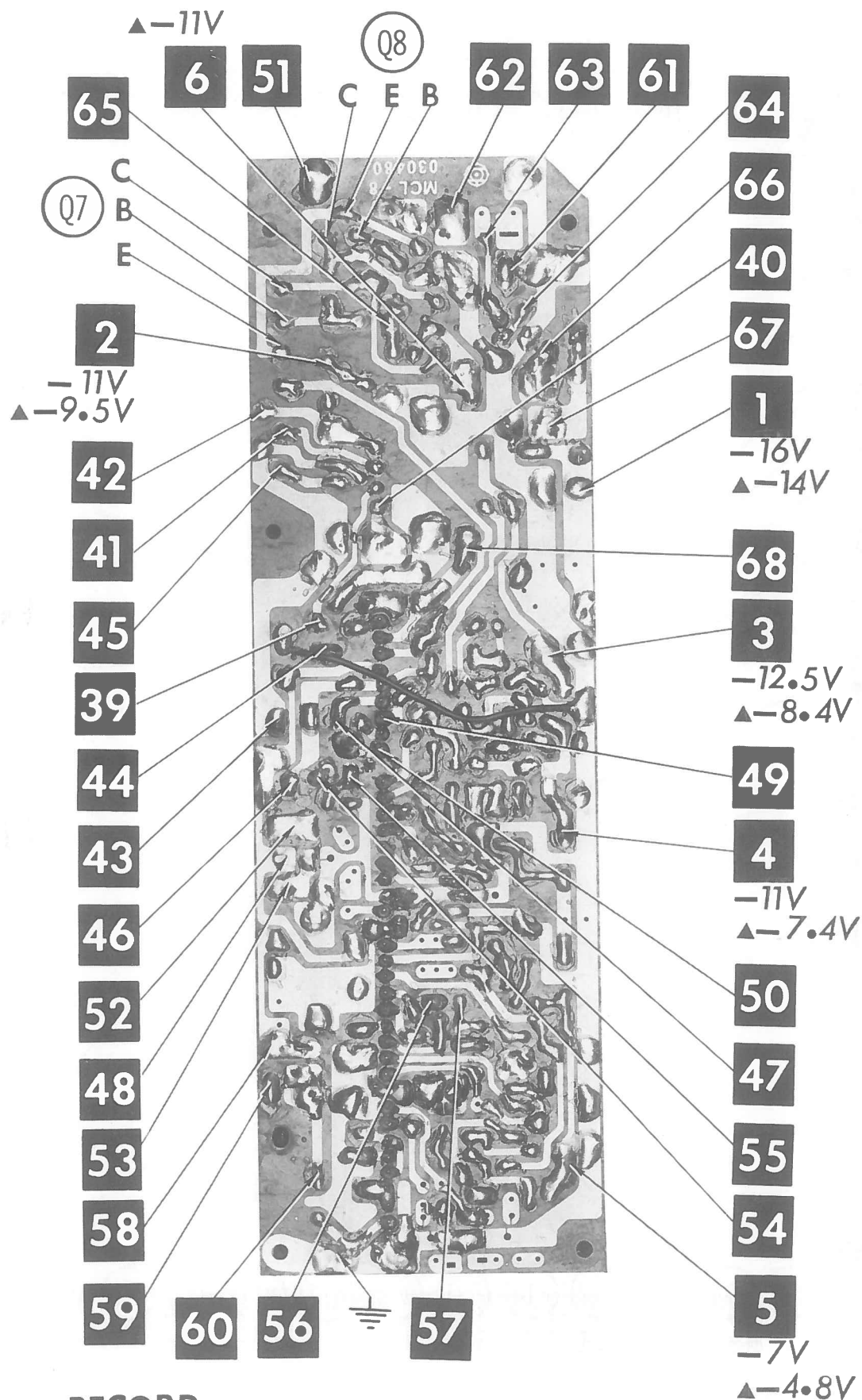

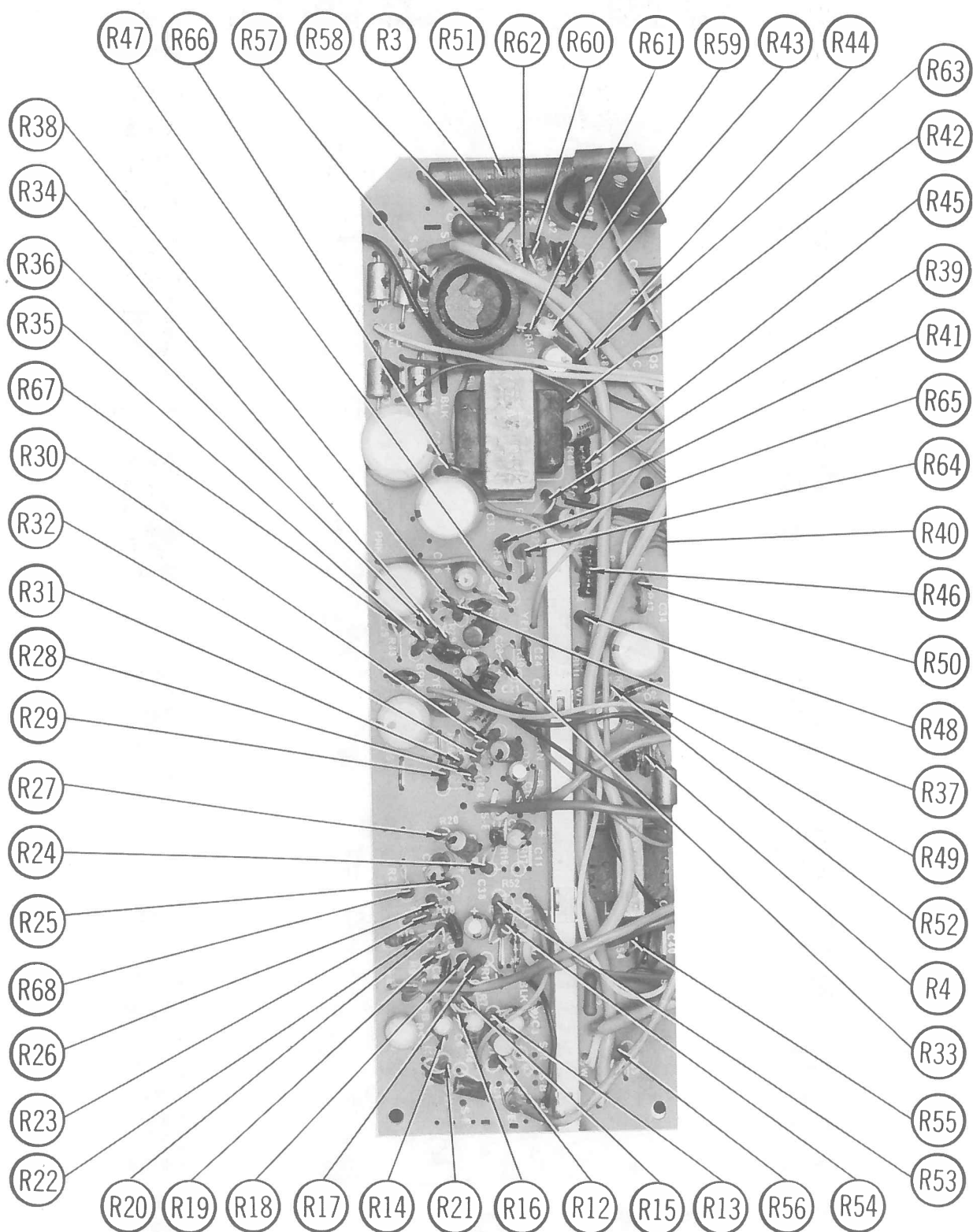

PARTS LIST AND DESCRIPTION

(When ordering parts, state Model, Part Number, and Description.)

WIRING DATA

General-use Unshielded Hook-up Wire	Use BELDEN No. 8530 (Solid) Available in 12 Colors 8524 (Stranded) Available in 12 Colors
Power Cord	Use BELDEN No. 17106 (Plastic) or 17126 (Rubber) - 6 Ft. 17109 (Plastic) or 17129 (Rubber) - 9 Ft.
Low-Loss Shielded Lead (Interconnecting)	Use BELDEN No. 8401 or 8421
Phono Pick-up Arm Cable	Use BELDEN No. 8430 (Two Conductor-Unshielded) 8429 (Two Conductor-Shielded) 8419 (Three Conductor-Shielded)

TRANSISTORS

ITEM No.	TYPE No.	FUNCTION	REPLACEMENT DATA					
			MFGR. PART No.	DELCO PART No.	GENERAL ELECTRIC PART No.	INTERNATIONAL RECTIFIER PART No.	RCA PART No.	SYLVANIA PART No.
Q1	2SB73	Preamp	123806	DS-26	GE-2	TR-05	SK-3004	ECG 102
Q2	2SC281	Preamp	123807	DS-74	GE-17	TR-22	SK-3018	ECG 108
Q3	2SC281	AF Amp	123807	DS-74	GE-17	TR-22	SK-3018	ECG 108
Q4	2SB77	Driver	123809	DS-26	GE-2	TR-05	SK-3004	ECG 102
Q5	2SB367	Output	123808					ECG 131
Q6	2SB367	Output	123808					ECG 131
Q7	2SB77	Bias Oscillator	123809	DS-26	GE-2	TR-05	SK-3004	ECG 102
Q8	2SB77	Bias Oscillator	123809	DS-26	GE-2	TR-05	SK-3004	ECG 102
Q9	HV-16	Meter Rectifier	123805	DS-26	GE-2	TR-05	SK-3004	ECG 102

POWER RECTIFIERS & SIGNAL DIODES

ITEM No.	MFGR. PART OR TYPE No.	REPLACEMENT RECTIFIERS & DIODES			REPLACEMENT RECTIFIERS		NOTES
		GENERAL ELECTRIC PART No.	INTERNATIONAL RECTIFIER PART No.	SYLVANIA PART No.	RCA PART No.	SARKES TARZIAN PART No.	
X1	123804 (1S310)	GE-504A	8D4 or 5A4-D	ECG 116 or ECG 117	SK-3030 or SK-3031	40C or F-4	
X2	123804 (1S310)	GE-504A	8D4 or 5A4-D	ECG 116 or ECG 117	SK-3030 or SK-3031	40C or F-4	
X3	123804 (1S310)	GE-504A	8D4 or 5A4-D	ECG 116 or ECG 117	SK-3030 or SK-3031	40C or F-4	
X4	123804 (1S310)	GE-504A	8D4 or 5A4-D	ECG 116 or ECG 117	SK-3030 or SK-3031	40C or F-4	
X5	1N34A	1N34AS	1N34A	ECG 109			
X6	1N34A	1N34AS	1N34A	ECG 109			

ELECTROLYTIC CAPACITORS

ITEM No.	RATING	REPLACEMENT DATA						
		RCA PART No.	AEROVOX PART No.	CENTRALAB PART No.	CORNELL-DUBILIER PART No.	GENERAL ELECTRIC PART No.	MALLORY PART No.	SPRAGUE PART No.
C1	500 25V	123797	PRS1290	EA30-500	BR500-25	QT1-31	TC2505B	TL-1217
C2	30 15V	123270	BCD15025	EP15-25	NLW30-15	MT1-16	MTV30CB25	TE-1158
C3	200 25V	123272	PRS1280	EA30-250	BR250-25	QT1-28	MTV200DJ25	TE-1213
C4	200 15V	123271	BCD20200	EA15-250	NLW200-15	MT1-23	MTV200CP15	TE-1164
C5	200 15V	123271	BCD20200	EA15-250	NLW200-15	MT1-23	MTV200CP15	TE-1164
C6	30 10V	117831	BCD10025	EP15-25	NLW30-15	MT1-16	MTV30CB25	TE-1132.1
C7	3 6V	120238	BCD6003	EP50-2	NLW3-15	MT1-3	MTV3CB50	TE-1082
C8	5 6V	116725	BCD6005	EP30-5	NLW5-15	MT1-3	PET1210	TE-1084
C9	1 6V	117194	BCD6001	EP50-2	NLW1-6	MT1-1	MTV1CB50	TE-1080
C10	5 6V	116725	BCD6005	EP30-5	NLW5-15	MT1-3	PET1210	TE-1084
C11	1 6V	117194	BCD6001	EP50-2	NLW1-6	MT1-1	MTV1CB50	TE-1080
C12	1 10V	116728	BCD12001	EP50-2	NLW1-50	MT1-1	MTV1CB50	TE-1120
C13	10 6V	117713	BCD6010	EP6-10	NLW10-6	MT1-5	MTV10CB50	TE-1087
C14	1 6V	117194	BCD6001	EP50-2	NLW1-6	MT1-1	MTV1CB50	TE-1080
C15	1 6V	117194	BCD6001	EP50-2	NLW1-6	MT1-1	MTV1CB50	TE-1080
C16	30 6V	116727	BCD6025	EP6-25	NLW30-6	MT1-13	MTV30CB25	TE-1132.1
C17	10 6V	117713	BCD6010	EP6-10	NLW10-6	MT1-5	MTV10CB50	TE-1087
C18	10 6V	117713	BCD6010	EP6-10	NLW10-6	MT1-5	MTV10CB50	TE-1087
C19	200 15V	123271	BCD20200	EA15-250	NLW200-15	MT1-23	MTV200CP15	TE-1164
C20	50 6V	117632	BCD6050	EP6-50	NLW50-6	MT1-15	MTV50CB15	TE-1133
C21	30 6V	116727	BCD6025	EP6-25	NLW30-6	MT1-13	MTV30CB25	TE-1132.1

(CONTINUED ON PAGE 120)

RCA MODEL YJH32W (Ch. TR1-5A)

NOTE: DEMAGNETIZE HEADS AFTER SERVICING RECORDER

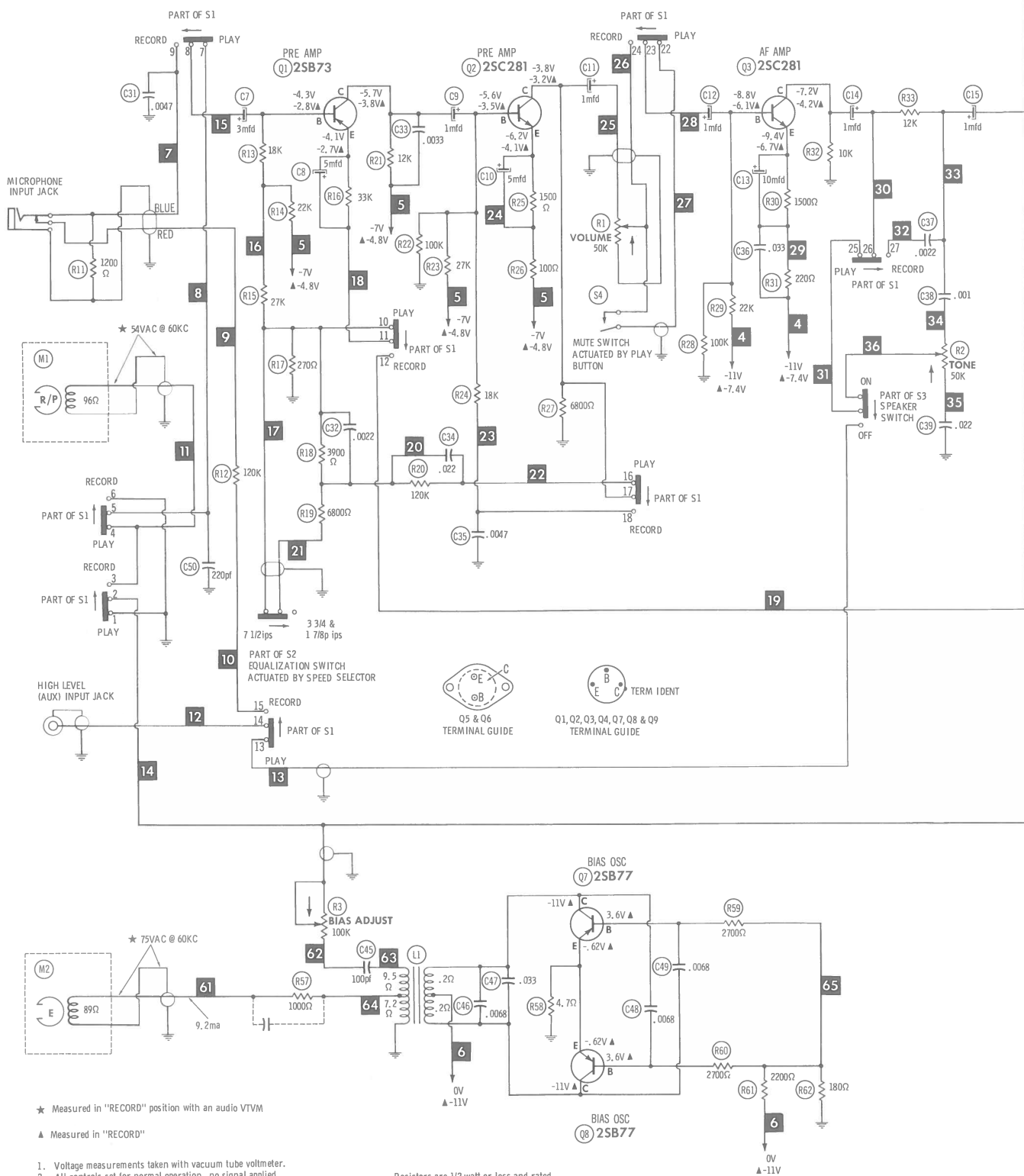

1. Voltage measurements taken with vacuum tube voltmeter.
2. All controls set for normal operation, no signal applied.
3. Measured values are from socket pin or terminal to common ground.
4. All terminals viewed from bottom unless otherwise designated.
5. Numbers assigned to terminals may not be found on the unit.
6. Supply voltage maintained at rated value for voltage readings.
7. Resistance measurements not given because of the wide variation in internal resistance of transistor.

Resistors are 1/2 watt or less and rated 10% or 20% unless otherwise indicated.

Arrows at controls indicate clockwise rotation viewed from actuator end

A PHOTOFAC[®] STANDARD NOTATION SCHEMATIC
with **CIRCUITRACE[®]**

© Howard W. Sams & Co., Inc. 1968

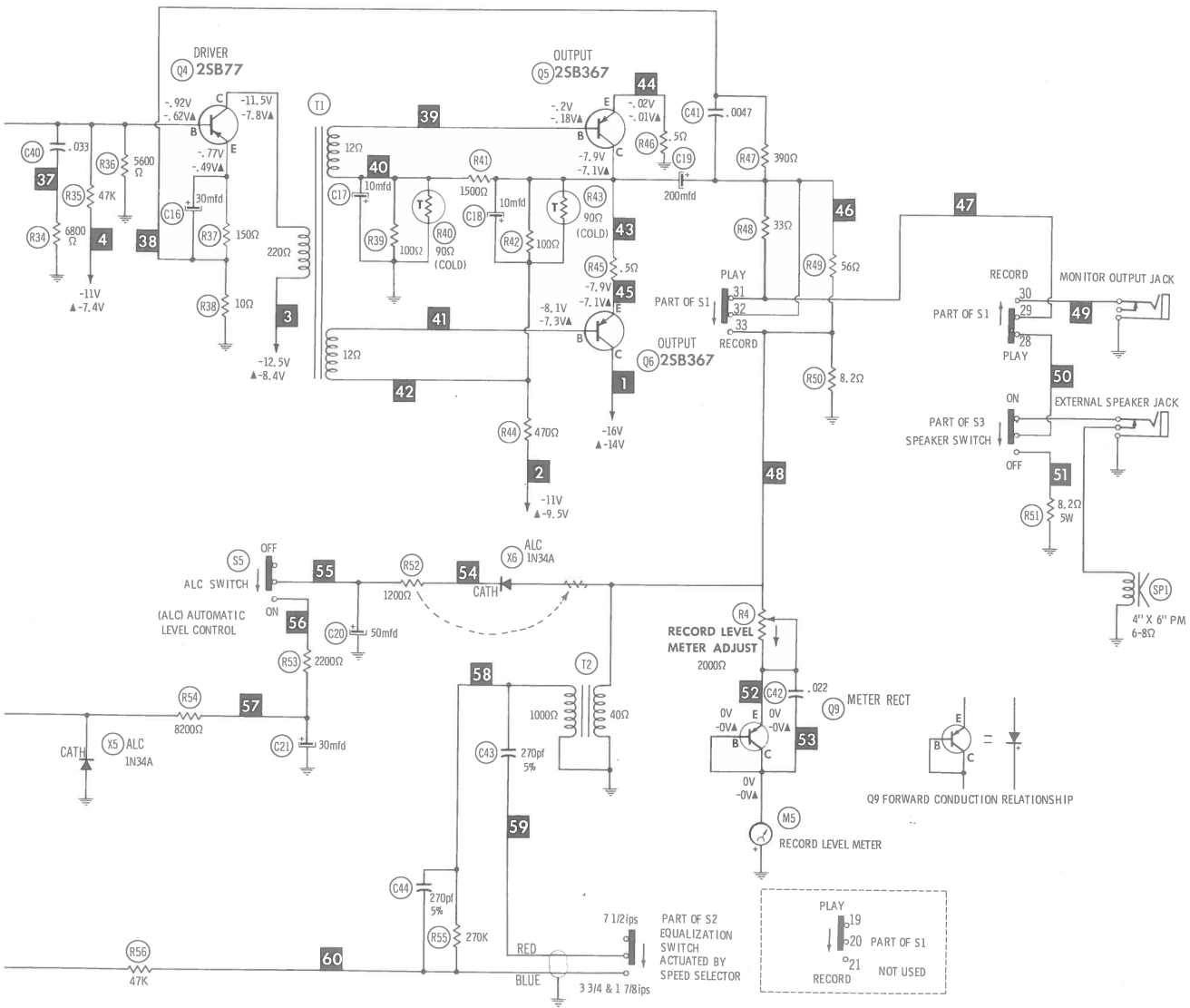

1	2	3	4	5	6	7	8	9	10	11	12	13	14	15	16	17	18	19	20	21	22	23	24	25	26	27	28	29	30	31	32	33	34	35	36
---	---	---	---	---	---	---	---	---	----	----	----	----	----	----	----	----	----	----	----	----	----	----	----	----	----	----	----	----	----	----	----	----	----	----	----

5" PLAY-RECORD SWITCH TERMINAL GUIDE

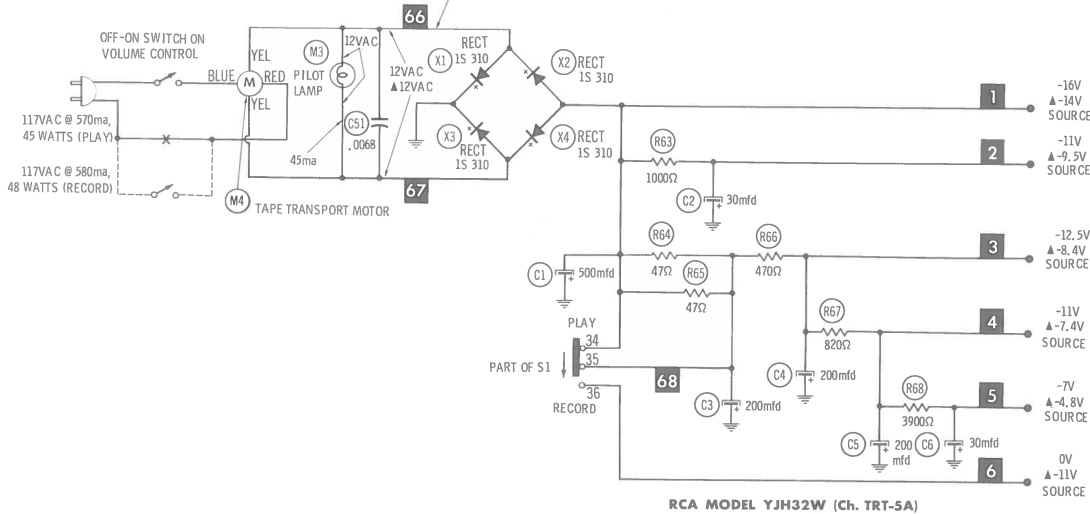

PARTS LIST AND DESCRIPTION (CONTINUED)

(When ordering parts, state Model, Part Number, and Description.)

CAPACITORS

ITEM No.	RATING	REMARKS	REPLACEMENT DATA					
			AEROVOX PART No.	CENTRALAB PART No.	CORNELL-DUBILIER PART No.	ELMENCO PART No.	MALLORY PART No.	SPRAGUE PART No.
C31	.0047 50V		GPD X5R472K	DD-472G	JBT601YP472K	CCD-472	JF247	2SS-D47
C32	.0022 50V		GPD X5F222K	DD-222	JBX601YP222K	CCD-222	GP222	2SS-D22
C33	.0033 50V		GPD X5R332K	DD-332	JBV601YP332K	CCD-332	JF233	10TS-D33
C34	.022 50V		GPD Z5U203P	DD-203	BYT601ZU203Z	CCD-203	GP120	10TS-S20
C35	.0047 50V		GPD X5R472K	DD-472G	JBT601YP472K	CCD-472	JF247	2SS-D47
C36	.033 50V		GPD Z5V303P	DD-303			GP130	
C37	.0022 50V		GPD X5F222K	DD-222	JBX601YP222K	CCD-222	GP222	2SS-D22
C38	.001 50V		GPD X5F102K	DM-102	JBS601YP102K	CCD-102	SM210	2SS-D10
C39	.022 50V		GPD Z5U203P	DD-203	BYT601ZU203Z	CCD-203	GP120	10TS-S20
C40	.033 50V		GPD Z5V303P	DD-303			GP130	
C41	.0047 50V		GPD X5R472K	DD-472G	JBT601YP472K	CCD-472	JF247	2SS-D47
C42	.022 50V		GPD Z5U203P	DD-203	BYT601ZU203Z	CCD-203	GP120	10TS-S20
C43	270 5%		ADM-15-271	CPR-270J	CD15F271J500	DM-15-271	SX327	MS-327
C44	270 5%		ADM-15-271	CPR-270J	CD15F271J500	DM-15-271	SX327	MS-327
C45	100		GPD X5F101K	DD-101	JBZ601YP101K	CCD-101	GP310	10TS-T10
C46	.0068 50V		GPD X5R682K	DD-682	BYX601ZU682P	CCD-682	JF268	10TS-D68
C47	.033 50V		GPD Z5V303P	DD-303			GP130	
C48	.0068 50V		GPD X5R682K	DD-682	BYX601ZU682P	CCD-682	JF268	10TS-D68
C49	.0068 50V		GPD X5R682K	DD-682	BYX601ZU682P	CCD-682	JF268	10TS-D68
C50	220		GPD X5F221K	DD-221	JBZ601YP221K	CCD-221	GP322	10TS-T22
C51	.0068 50V		GPD X5R682K	DD-682	BYX601ZU682P	CCD-682	JF268	10TS-D68

CONTROLS (All wattages 1/2 watt, or less, unless listed)

ITEM No.	FUNCTION	RESIST-ANCE	REPLACEMENT DATA				
			MFGR. PART No.	CENTRALAB PART No.	CLAROSTAT PART No.	CTS-IRC PART No.	MALLORY PART No.
R1A B	Volume On/Off Switch	50K	123814	F2-50K(1),SSK100, KR-1	A47-50K-Z(1), KSS-3,SWE-12 or (NP-50K-Z(1), UP-C-400,NWE-12)	Q13-123(1),76-1 or (BU1(1),CF63, SS1,GC)*	RU54A,SL36, SL3250,US41 or (UA54A(1),SK3500, US41) or (U33(1), US26)
R2	Tone	50K	123815	F2-50K(1),SSK100	A47-50K-Z(1), KSS-3 or (NP-50K-Z(1), UP-C-400)	Q13-123(1) or (BU1(1),CF63, SS1,DC1)*	RU54A,SL36,SL3250 or (UA54A(1), SK3500) or (U33(1))
R3 R4	Record Bias Adjust Record Level Meter Adjust	100K 2000	(2) 123816	TH-100K(3) (4) TH-2500 (3) (4)		X201R104B(4) X201R252B(4)	MTC15L1(4) MTC23L1(4)

* "SNAPTROL"

(1) Enlarge mounting hole.
(3) Cut off mounting studs.

(2) Alternate value 250K, Part Number 123817.

(4) Cut off one of the outside terminals, bend terminals to fit "PC" board.

RESISTORS (Power and Special)

ITEM No.	RATING	REPLACEMENT DATA			ITEM No.	RATING	REPLACEMENT DATA		
		IRC PART No.	WORKMAN PART No.	MFGR. PART No.			IRC PART No.	WORKMAN PART No.	MFGR. PART No.
R40	90 (Cold) Thermistor		GM100	123813	R51	8.2,5W	PW5-7.5	5W-SQ 7.5	123803
R43	90 (Cold) Thermistor		GM100	123813					

COILS (RF-IF)

ITEM No.	USE	REPLACEMENT DATA			
		PART No.	MEISSNER PART No.	MILLER PART No.	WORKMAN PART No.
L1	Bias Oscillator	123812			

TRANSFORMER (Driver)

ITEM No.	TURNS RATIO			REPLACEMENT DATA					NOTES
				RCA PART No.	MERIT PART No.	STANCOR PART No.	THORDARSON PART No.	TRIAD PART No.	
	PRI.	SEC. 1	SEC. 2						
T1	3.8	1	1	123810 (441054)					

PARTS LIST AND DESCRIPTION (CONTINUED)

(When ordering parts, state Model, Part Number, and Description.)

TRANSFORMER

ITEM No.	TURNS RATIO			REPLACEMENT DATA					NOTES
	PRI.	SEC. 1	SEC. 2	RCA PART No.	MERIT PART No.	STANCOR PART No.	THORDARSON PART No.	TRIAD PART No.	
T2	1	18.5		123811					

SPEAKER

ITEM No.	TYPE			REPLACEMENT DATA			NOTES
				RCA PART No.	JENSEN PART No.	QUAM PART No.	
SP1	4" X 6"	PM	8 ohms	123836			

TAPE HEADS

ITEM No.	MEASURED			RCA PART NO.	NORTRONICS PART NO.	DESCRIPTION
	INDUCTANCE	BIAS/ERASE VOLTS (RMS)	BIAS FREQ.			
M1	320mh	54Vrms	60KC	123711	3101 (1)	2-Track Monaural Record/Play
M2	35mh	75Vrms	60KC	123710	3600 & QK-19	2-Track Monaural Erase

(1) Cement to original mounting.

MISCELLANEOUS

ITEM No.	PART NAME	PART No.	NOTES
M3	Pilot Lamp	123700	Indicator
M4	Motor	123699	Tape Transport and Power Transformer
M5	Meter	123712	Record Level
M6	Microphone	123843	200 ohms, Includes Cord and Stand
S1	Switch	123689	Record/Play
S2	Switch		Equalization
S3	Switch	123714	Speaker, On/Off
S4	Switch	123693	Mute
S5	Switch	123713	ALC (Automatic Level Control)
	Printed Circuit Board	123795	Complete

CABINETS & CABINET PARTS (When ordering specify model, chassis & color)

ITEM	PART No.	ITEM	PART No.
Cabinet, Center Section (Walnut)	123819	Head Cover	123829
Rear Cover	123825	Handle, Carrying (2 Required)	123822
Accessory Compartment Cover	123826	Knob, Pause	123830
Front Cover (Beige)	123828	Knob, Speed Selector	123831
Escutcheon, Front Panel	123818	Knob, Volume and Tone	123832

RCA MODEL YJH32W (Ch. TRT-5A)